

PARTS LIST 14-117

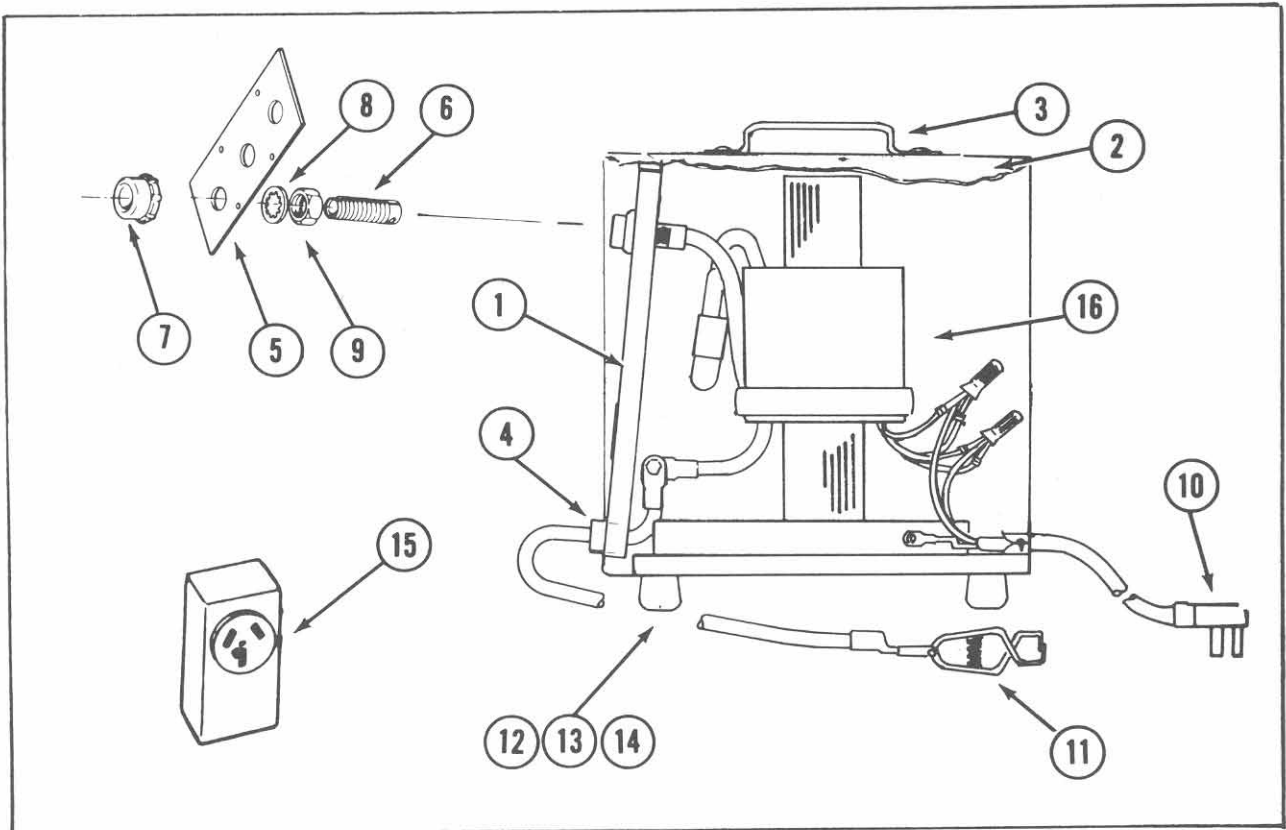

ITEM	PART NO.	DESCRIPTION	ITEM	PART NO.	DESCRIPTION
1	619-58285	Front and Base Assy.	9	699-50763	Terminal Post Nut (Hex)
2	617-58309	Wrap Assy.	10	633-58264	Power Cord Assy.
3	652-58115	Handle	11	634-58291	Work Cable Assy.
4	665-41047	Work Lead Bushing	12	612-43951	Metal Foot
5	613-40222	Terminal Panel	13	629-43872	Rubber Foot
6	611-50765	Terminal Post	14	699-49786	Foot Screw
7	699-40529	Terminal Nut (Nylon)	15	15-914	Receptacle
8	699-50976	Lock Washer	16	618-58303	Transformer Assy. *

ORDERING INSTRUCTIONS

To avoid delays and assure correct replacement parts, always include the following information with the parts order:

1. Model and serial number. 2. Part number and description. 3. Quantity of parts desired.

NOTE: Do not use item numbers when ordering replacement parts.

* Transformer and Reactor Assembly sold complete.

For parts prices, refer to current Parts Price List. All parts FOB shipping point. Manufacturer reserves the right to make changes in design, construction or materials as necessary.