



IM-191-B

Shield-Arc SAE-400
Hercules
IM191
March, 1957
2456; 2457; 2458;
2459; 2460; 2461;
2475; 2676; 2677; 3310

PARTS LIST

Generator & Engine

MASTED

"Shield-Arc" SAE-400 DC Welder

Powered by HERCULES JXD Gasoline Engine

NET

Sent a copy

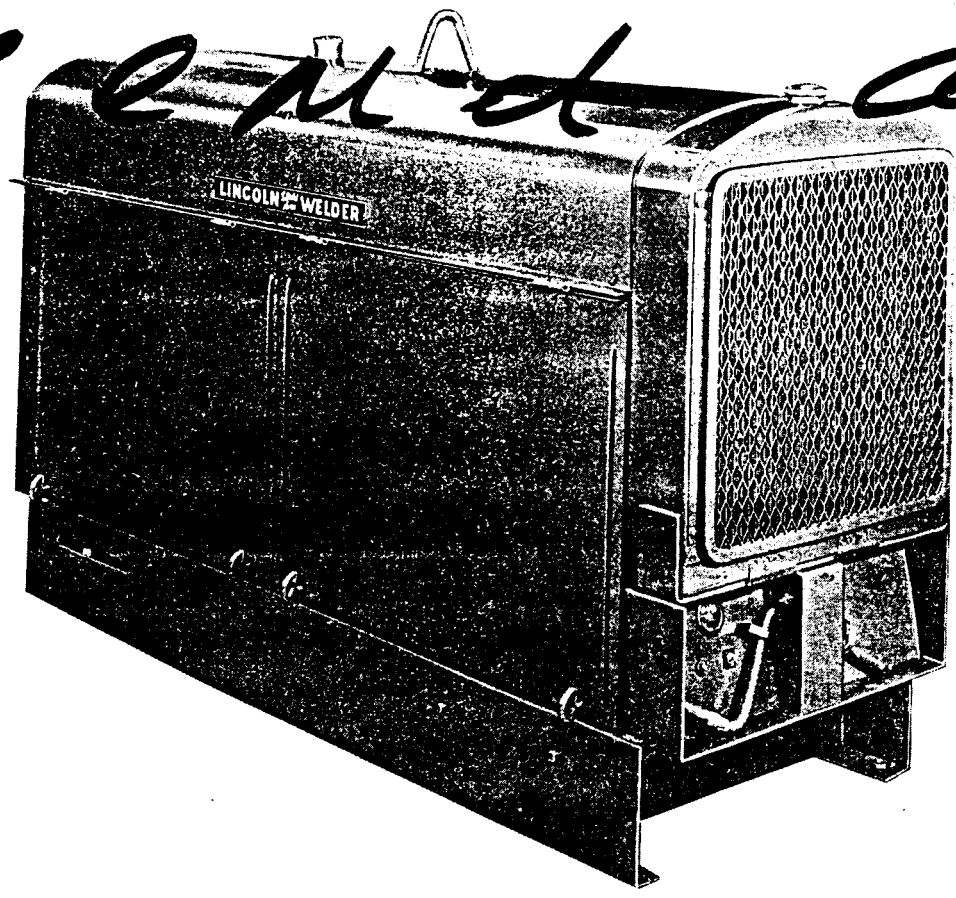

This manual covers equipment which is obsolete and no longer in production by The Lincoln Electric Co. Specifications and availability of optional features may have changed.

Type: S-7066

THE LINCOLN ELECTRIC COMPANY

The World's Largest Manufacturer of Arc Welding Equipment

Cleveland 17, Ohio

CONTENTS

How to Use Parts List	3
Code Table Index	3
Exterior - Radiator End	4
Exterior - Control End	5
Interior - Output Terminals Side.....	6 - 7
Interior - Oil Filter Side.....	8
Control Box	9
Generator	10
Brush Holder	11
FDR Exciter	12
FDR Brush Holder	13
Brush Holder	14
S-7295 Dimension Print	15
M-5570 Wiring Diagram	15

HOW TO USE PARTS LIST

The following pages contain a complete description and identification of the various parts for welders described in this manual. This includes:

1. Photographs and drawings of the welder. The parts are identified by item numbers referring to the corresponding parts list.
2. A "Parts List" corresponding to each "Photograph". The item number found on the "Photograph", when referred to in the "Parts List", will give complete information as to the Lincoln ordering part number and quantity required for each code number of that welder.
3. The "Code Table" wherein you determine the correct column of the "Parts List" to use for the particular code number of your welder. The "Code Table" also lists diagrams, coils, etc. which are not listed on the individual "Parts List".

Assume that we want to look up the part number for the voltmeter of our welder.

STEPS

- Step #1** Look on nameplate of welder for the model, code and serial number.
- Step #2** Turn to the proper photograph or drawing in which the part or parts involved appear.
- Step #3** Select the item number for the part involved.
- Step #4** Look in the left-hand column of the code table for your code number. Follow that line across to the column headed by the number of the parts list being used. Read the letter found there. This letter is the heading for the proper column to use in the parts list.
- Step #5** Look on the parts list for the item number picked in Step 3 above and look across to the column found in Step 5. The items marked with X's in this column indicate use of the part listed. Those items marked by dots in this column do not use this part. Items indented in the part name column, but which have no item number of their own, are included as part of the assembly of the item listed. They may be ordered separately, if desired.
- Step #6** When ordering part you have selected, specify:

EXAMPLE

Type S-7066, Code 2458, Serial 395123.

Rear Door & Lower Panel Assembly appears on page 5. (Use Parts List 2)

Item #7.

"A".

M-6491 is used.
S-8956-1 is not used.

Order:

One M-6491 Rear Door, etc. SAE 400 Hercules JXD Engine Welder. Serial 82555, Code 2458.

CODE TABLE INDEX FOR PARTS LISTS, COILS, DIAGRAMS, ETC.											PARTS LISTS											
SERIES	SHUNT COIL	INTERPOLE COIL	ARMATURE SPEC	EXCITER FIELD COIL	EXCITER ARMATURE SPEC	INTERNAL GENERATOR DIAGRAM	EXCITER DIAGRAM	CONTROL DIAGRAM	IGNITION DIAGRAM	TYPE	CODE	I	II	III	IV	V	VI	VII	VIII	IX	X	
												LETTERS BELOW INDICATE PROPER PARTS LIST COLUMNS TO USE FOR INDIVIDUAL UNIT'S CODE NUMBER.										
FLW-420C	FLW-405B	S-5086-1	FLW 37.4L	FDW-SE	FDW 24.28A	M-5570	E-275-C	L-2333-14	Y-8595	FLW-FDW	2456	A	A	A	A	A	A	A	A	A	A	A
FLW-420C	FLW-405B	S-5086-1	FLW 37.4L	FDW-SE	FDW 24.28A	M-5570	E-275-C	L-2333-14	Y-8572	FLW-FDW	2457	B	A	B	B	A	A	A	A	A	A	A
FLW-420C	FLW-405B	S-5086-1	FLW 37.4L	FDW-SE	FDW 24.28A	M-5570	E-275-C	L-2333-14	Y-8595	FLW-FDW	2458	C	A	C	A	A	A	A	A	A	A	A
FLW-420C	FLW-405B	S-5086-1	FLW 37.4L	FDR 125A	FDR 24.16	M-5570	E-1019	L-2333-24	R-8595	FLW-FDR	2459	D	B	A	C	A	B	A	A	A	A	C
FLW-420C	FLW-405B	S-5086-1	FLW 37.4L	FDR 125A	FDR 24.16	M-5570	E-1019	L-2333-24	Y-8572	FLW-FDR	2460	E	B	B	D	A	B	A	A	A	A	C
FLW-420C	FLW-405B	S-5086-1	FLW 37.4L	FDR 125A	FDR 24.16	M-5570	E-1019	L-2333-14	Y-8595	FLW-FDR	2461	F	B	C	C	A	B	A	A	A	A	C
FLW-420C	FLW-405B	S-5086-1	FLW 37.4L	FDR 125A	FDR 24.16	M-5570	E-1019	L-2333-14	Y-8572	FLW-FDW	2875	A	A	A	A	A	A	A	A	A	A	A
FLW-420C	FLW-405B	S-5086-1	FLW 37.4L	FDR 125A	FDR 24.16	M-5570	E-275-C	L-2333-14	Y-8572	FLW-FDW	2876	B	A	B	B	A	A	A	A	A	A	A
FLW-420C	FLW-405B	S-5086-1	FLW 37.4L	FDR 125A	FDR 24.16	M-5570	E-275-C	L-2333-14	Y-8595	FLW-FDW	2877	C	A	C	A	A	A	A	A	A	A	A
FLW-420C	FLW-405B	S-5086-1	FLW 37.4L	FDR 125B	FDR 24.16	M-5570	E-1019	L-2333-24	Y-8595	FLW-FDR	3370	C	B	C	A	A	B	A	A	A	A	C

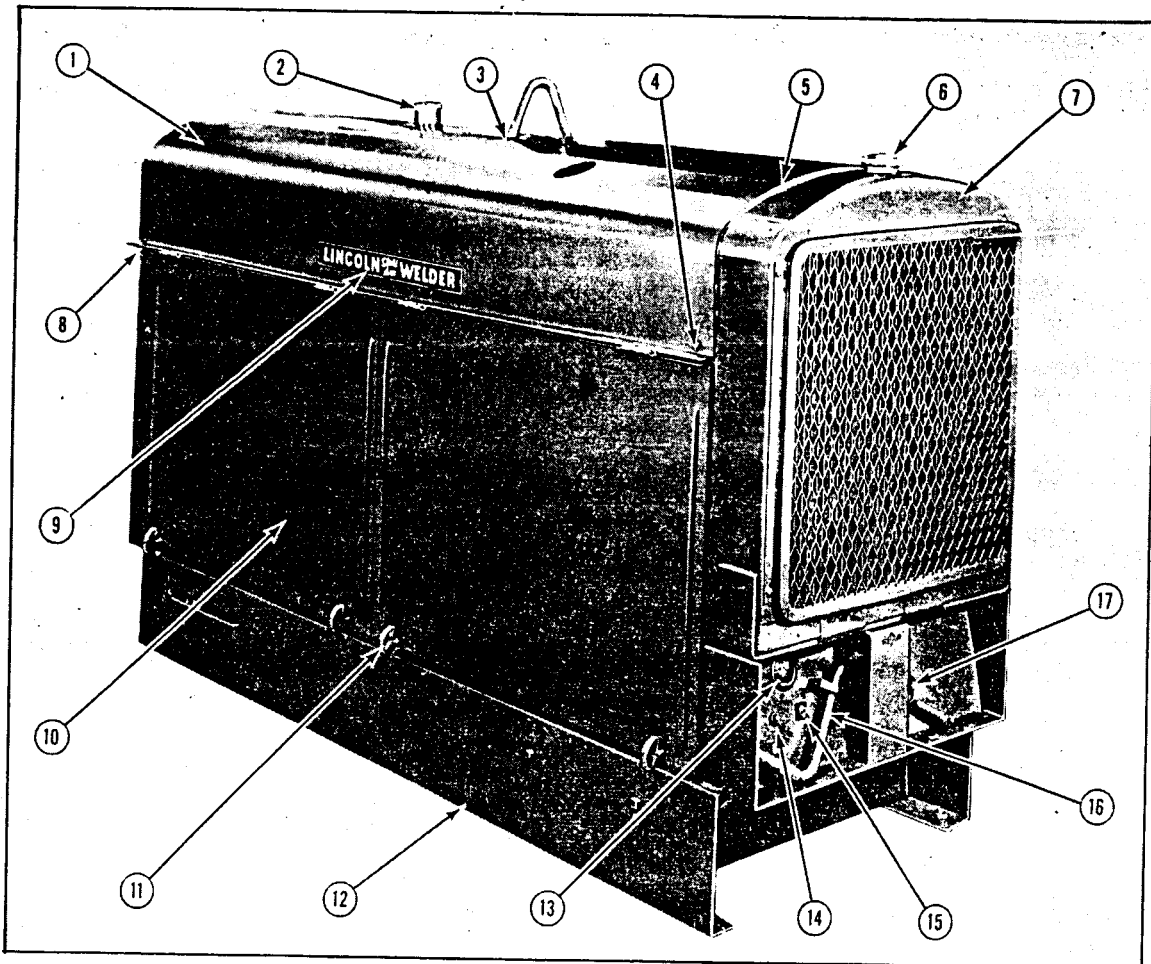

EXTERIOR - RADIATOR END

PARTS LIST I FOR FIGURE 1 EXTERIOR - RADIATOR END SAE-400 HERCULES JXD ENGINE WELDER					P-22-B																									
					USE ONLY PARTS MARKED "X" IN COLUMNS BELOW UNDER LETTER CALLED FOR IN CODE TABLE INDEX																									
ITEM	PART NAME AND DESCRIPTION	PART No.	REQ'D.	A	B	C	D	E	F	G	H	J	K	L	M	N	P	Q	R	S	T	U	V	W	X	Y	Z			
1	Roof																													
2	Cap - Gas Tank	L-2505-2	1	X	X	X	X	X	X																					
3	Seal - Lift Bale	S-8000	1	X	X	X	X	X	X																					
4	Hook - Front Roof Mounting	T-9129	1	X	X	X	X	X	X																					
	Lockwasher	T-8818	2	X	X	X	X	X	X																					
	Hex Nut	E-106-A-3	2	X	X	X	X	X	X																					
5	Anti-Squeak Strip - Radiator	S-9032-1	2	X	X	X	X	X	X																					
6	Cap - Radiator	S-8353	1	X	X	X	X	X	X																					
7	Radiator	G-946-2	1	X	X	X	X	X	X																					
	Plain Washer - Radiator Mounting	S-9262-5	2	X	X	X	X	X	X																					
	Lockwasher	E-106-A-5	2	X	X	X	X	X	X																					
	Hex Nut	1/2-13	2	X	X	X	X	X	X																					
8	Mounting Angle - Rear Roof Mounting	T-9428	2	X	X	X	X	X	X																					
	Lockwasher	E-106-A-3	2	X	X	X	X	X	X																					
	Hex Head Cap Screw	5/16-18 x 3/4	2	X	X	X	X	X	X																					
9	"Lincoln" Decal	M-5249-1	2	X	X	X	X	X	X																					
10	Door	M-7534-A	4	X	X	X	X	X	X																					
11	Door Hook	S-8929-1	8	X	X	X	X	X	X																					
	Spring	T-9721-1	8	X	X	X	X	X	X																					
	Cotter Pin	1/8 x 1 Standard	8	X	X	X	X	X	X																					
12	Base Assembly	L-3035	1	X	X	X	X	X	X																					
13	Ammeter	S-7514	1	X	X	X	X	X	X																					
14	Starter Button	T-9623	1	X	X	X	X	X	X																					
15	Ignition Switch	S-8080	1	X	X	X	X	X	X																					
	Switch Plate	T-9061	2	X	X	X	X	X	X																					
16	Crank	S-7430	1	X	X	X	X	X	X																					
	Crank Batchet - Mounted on Crankshaft	S-7529	1	X	X	X	X	X	X																					
17	Holder Bracket Assembly - Crank	T-10223	2	X	X	X	X	X	X																					
	Choke Rod Assembly	S-7525	1	X	X	X	X	X	X																					
	Exhaust Pipe	S-7435	1	X	X	X	X	X	X																					

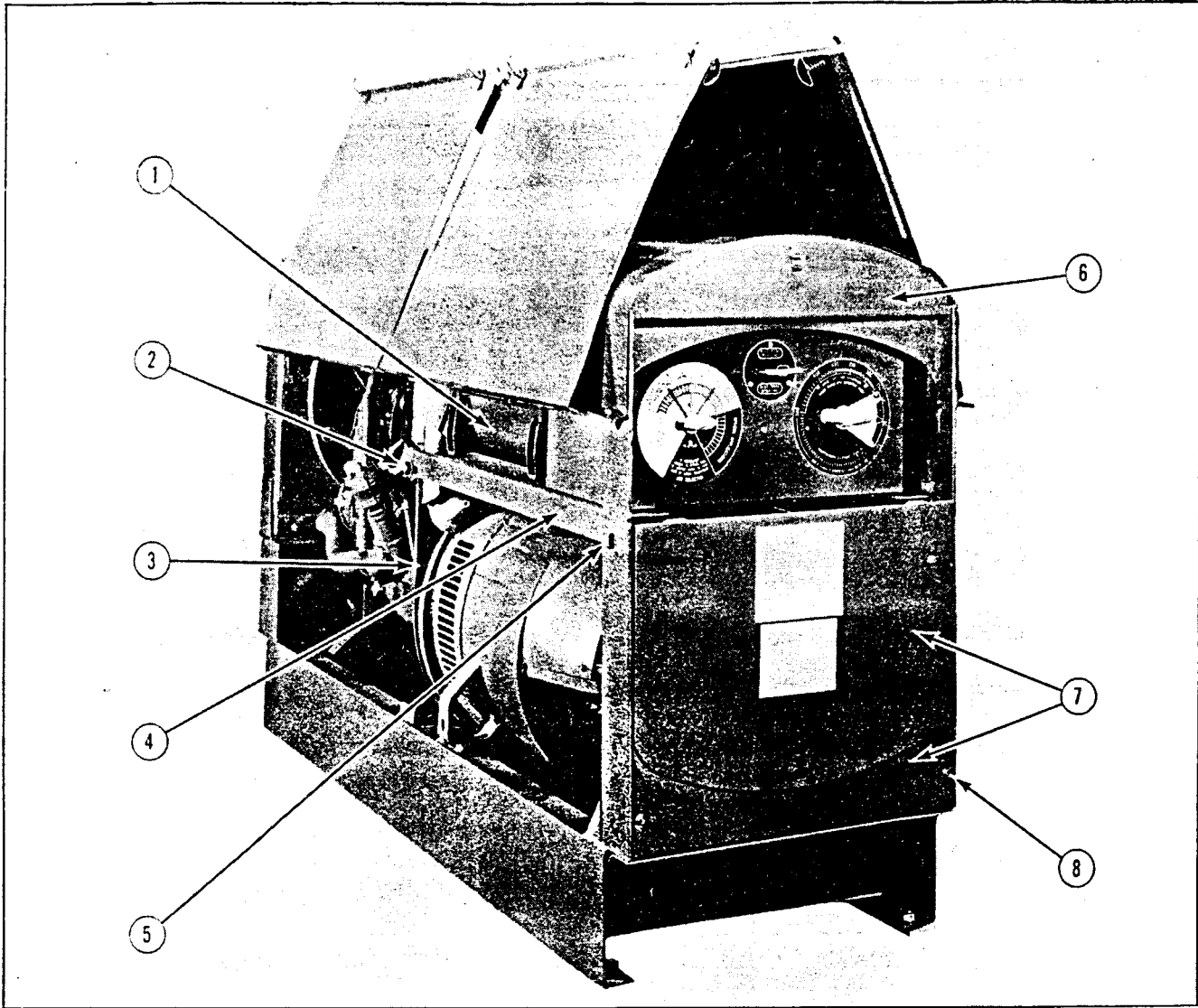

EXTERIOR - CONTROL END

PARTS LIST II FOR FIGURE II EXTERIOR - CONTROL END SAE-400 HERCULES JXD ENGINE WELDER											P-22-C																
USE ONLY PARTS MARKED "X" IN COLUMNS BELOW UNDER LETTER CALLED FOR IN CODE TABLE INDEX																											
ITEM	PART NAME AND DESCRIPTION	PART No.	REQ'D.	A	B	C	D	E	F	G	H	J	K	L	M	N	P	Q	R	S	T	U	V	W	X	Y	Z
1	Gas Tank	L-3398-5	1		X	X																					
	Square Head Cap Screw - Gas Tank Mounting	3/8-16 x 1	4		X	X																					
	Lockwasher	E-106-A-4	4		X	X																					
	Square Nut	3/8-16	4		X	X																					
	Gas Strainer	S-6185	1		X	X																					
2	Square Head Cap Screw - Front - Rail Mounting	1/2-13 x 1-1/2	2		X	X																					
	Plain Washer	S-9262-5	2		X	X																					
	Lockwasher	T-9860-2	4		X	X																					
3	Housing Plate (Includes Lift Bale)	L-2463	1		X	X																					
4	Side Rail	S-5610	1		X	X																					
5	Square Head Bolt - Rear - Rail Mounting	1/2-13 x 1-1/2	2		X	X																					
	Plain Washer	S-9262-5	2		X	X																					
	Spacer	T-7214-A	2		X	X																					
	Lockwasher	E-106-A-5	2		X	X																					
	Square Nut	1/2-13	2		X	X																					
6	Rear Upright Support Assembly	M-6466	1		X	X																					
7	Rear Door and Lower Panel Assembly	M-6467	1		X	X																					
7	Rear Door and Lower Panel Assembly	S-8958-1	1		X	X																					
8	Thread Cutting Screw - Rear Door Mounting	S-9225-2	4		X	X																					

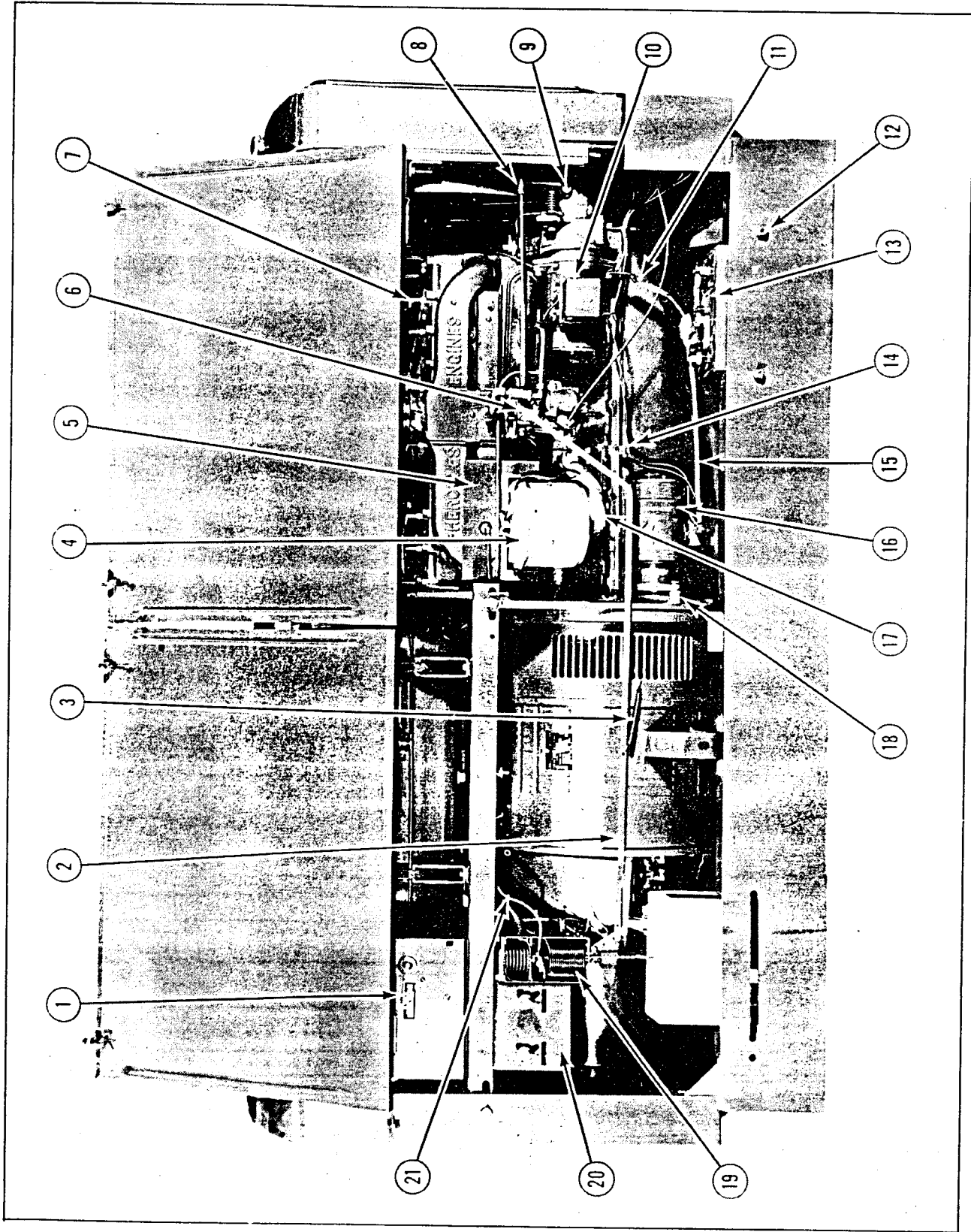

INTERIOR - OUTPUT TERMINALS SIDE

PARTS LIST III FOR FIGURE III INTERIOR - OUTPUT TERMINALS SIDE SAE-400 HERCULES JXD ENGINE WELDER					USE ONLY PARTS MARKED "X" IN COLUMNS BELOW UNDER LETTER CALLED FOR IN CODE TABLE INDEX																									
ITEM	PART NAME AND DESCRIPTION	PART No.	REQ'D.																											
				A	B	C	D	E	F	G	H	J	K	L	M	N	P	Q	R	S	T	U	V	W	X	Y	Z			
1	Instruction Decal	T-10829	1	X	X	X																								
2	Throttle Rod - Engine Idler to Carburetor	S-9388	1	X	X	X																								
	Round Head Cap Screw	#10-24 x 1-1/2	2	X	X	X																								
	Lockwasher	E-106-A-1	2	X	X	X																								
	Hex Nut	#10-24	3	X	X	X																								
3	Throttle Spring	T-9284	1	X	X	X																								
4	Air Cleaner	M-7767-1	1	X	X	X																								
	Square Head Set Screw - Cup Point	1/4-20 x 3/4	2	X	X	X																								
	Hex Nut	1/4-20	2	X	X	X																								
5	Defroster Baffle	M-7618	1	X	X	X																								
6	Carburetor	S-8750	1	X	X	X																								
	Gas Line	S-4893-35	1	X	X	X																								
	Elbow - Carburetor End	T-8645	1	X	X	X																								
	Compression Connector	T-8644	1	X	X	X																								
	Line Clamp	T-4169	1	X	X	X																								
	Clamp Washer	T-9060	1	X	X	X																								
	Lockwasher	E-106-A-1	1	X	X	X																								
	Round Head Cap Screw	#10-24 x 1/2	1	X	X	X																								
	Hex Nut	#10-24	1	X	X	X																								
7	Spark Plug	S-7567	6	X	X	X																								
8	Governor Link Assembly Includes:	S-8541	1	X	X	X																								
	Tube	T-9572	1	X	X	X																								
	Shaft	T-9390	1	X	X	X																								
	Spring	T-9386	1	X	X	X																								
	Retainer Plug	T-9387	1	X	X	X																								
	Ball Socket - Governor	S-10623-1	2	X	X	X																								
	Hex Nut	1/4-28	3	X	X	X																								
	Lockwasher	E-106-A-2	1	X	X	X																								
9	Governor	M-7875	1	X	X	X																								
	Seal - Governor	T-8628	1	X	X	X																								
10	Generator With Cut-Out	M-7064	1	X	X	X																								
	Gear - Generator	S-7520	1	X	X	X																								
	Gasket - Generator	S-7527	1	X	X	X																								
	Hex Head Cap Screw - Generator Mounting	1/2-13 x 1	2	X	X	X																								
	Lockwasher	E-106-A-5	2	X	X	X																								
11	Ground Cable - Battery	S-8002	1	X	X	X																								
	Hex Head Cap Screw	5/16-18 x 1	1	X	X	X																								
	Plain Washer	S-9262-29	1	X	X	X																								
	Lockwasher	E-106-A-3	1	X	X	X																								
12	Battery Hanger	M-6532	1	X	X	X																								
	Clamp	S-7429	1	X	X	X																								
	Lockwasher	E-106-A-4	2	X	X	X																								
	Hex Nut	3/8-16	2	X	X	X																								
13	Battery (Dry)	M-6583-1	1	X	X	X																								
	Electrolyte	S-10590-2	1	X	X	X																								
14	Lead Clip - Mounted With Engine Pan Screw	T-9402	1	X	X	X																								
15	Starter Cable	S-5938-P	1	X	X	X																								
16	Starter	M-7065	1	X	X	X																								
17	Elbow Bracket - Air Cleaner	M-7767-1	1	X	X	X																								
18	Starter Spacer	S-7438	1	X	X	X																								
	Hex Head Cap Screw	3/8-16 x 2	3	X	X	X																								
	Lockwasher	E-106-A-4	3	X	X	X																								
19	Engine Regulator	See IM-117-B	1	X	X	X																								
	Hex Head Cap Screw - Regulator Mounting	1/4-20 x 3/8	2	X	X	X																								
	Lockwasher	E-106-A-2	2	X	X	X																								
	Copper Lead - Regulator to "Work" Stud	M-8772-34	1	X	X	X																								
	Square Head Cap Screw	3/8-16 x 1	2	X	X	X																								
	Lockwasher	E-106-A-4	2	X	X	X																								
	Square Nut	3/8-16	2	X	X	X																								
20	Side Ball Assembly Includes:	M-5952-A	1	X	X	X																								
	Ball Welded Assembly	M-4566	1	X	X	X																								
	Marker "To Work"	T-3962	1	X	X	X																								
	Marker "Electrode"	T-3961	1	X	X	X																								
	Hollow Rivet - Marker Mounting	T-8973	4	X	X	X																								
	Stud Assembly Includes:	T-8230-2	2	X	X	X																								
	Stud	T-6931	2	X	X	X																								
	Insulating Bushing	T-4122	2	X	X	X																								
	Insulating Washer	T-9696-9	4	X	X	X																								
	Plain Washer	S-9262-1	4	X	X	X																								
	Lockwasher	E-106-A-5	2	X	X	X																								
	Hex Jam Nut	T-10114	6	X	X	X																								
	Wing Nut	T-3960	2	X	X	X																								
21	Air Line Connector	S-8058-10	1	X	X	X																								
	Connector	T-9075	1	X	X	X																								

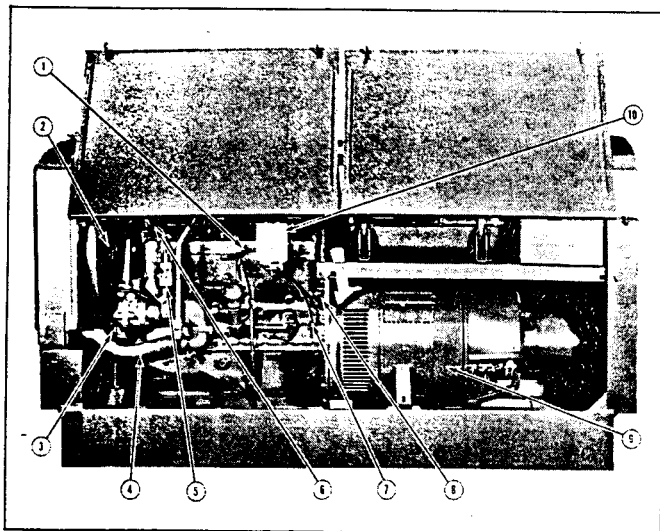

INTERIOR - OIL FILTER SIDE

PARTS LIST IV FOR FIGURE IV INTERIOR - OIL FILTER SIDE SAE-400 HERCULES JXD ENGINE WELDER				P-22-E USE ONLY PARTS MARKED "X" IN COLUMNS BELOW UNDER LETTER CALLED FOR IN CODE TABLE INDEX																									
ITEM	PART NAME AND DESCRIPTION	PART No.	REQ'D.	A	B	C	D	E	F	G	H	J	K	L	M	N	P	Q	R	S	T	U	V	W	X	Y	Z		
1	Oil Line	T-9955	1	X	X	X																							
2	Fan and Bracket Assembly includes:	M-6585	1	X	X	X	X																						
	Bracket	M-7208	1	X	X	X																							
	Clamping Washer	T-9354	1	X	X	X																							
	Adjusting Screw	T-9353	1	X	X	X																							
	Lockwasher	E-106-A-5	1	X	X	X																							
	Hex Nut	1/2-20	1	X	X	X																							
	Fan and Hub Assembly	M-7210	1	X	X	X																							
	Hex Head Cap Screw	1/2-13 x 1	2	X	X	X																							
	Lockwasher	E-106-A-5	2	X	X	X																							
	Fan Belt	S-7519	1	X	X	X																							
3	Hex Head Cap Screw - Front Engine Mounting	1/2-13 x 1	4	X	X	X	X																						
	Lockwasher	E-106-A-5	4	X	X	X	X																						
4	Lower Hose	M-7215	1	X	X	X																							
	Hose Clamp	T-8917	1	X	X	X																							
	Hose Clamp	T-8629	1	X	X	X																							
	Upper Hose	M-7217	1	X	X	X																							
	Hose Clamp	T-8917	1	X	X	X																							
	Hose Clamp	T-8629	1	X	X	X																							
5	Distributor	M-7405-1	1	X	X	X																							
	Clamp Arm	S-8521	1	X	X	X																							
	Clamp Arm Dial	S-8155	1	X	X	X																							
	Bracket	S-7517	1	X	X	X																							
	Hex Head Cap Screw	3/8-16 x 1-3/4	1	X	X	X																							
	Lockwasher	E-106-A-4	1	X	X	X																							
	Nipples	T-8627	8	X	X	X																							
5	Magneto Assembly includes:	S-8705	1	X	X	X																							
	Magneto	L-2759	1	X	X	X																							
	Switch Bracket	S-8142	1	X	X	X																							
	Switch Plate	T-9061	1	X	X	X																							
	Switch	S-8020	1	X	X	X																							
	Jumper Lead	T-9141	1	X	X	X																							
	Round Head Cap Screw - Lead Mounting	#8-32 x 1/4	1	X	X	X																							
	Lockwasher	#8 Standard	1	X	X	X																							
	Hex Head Cap Screw - Magneto Mounting	3/8-16 x 3/4	1	X	X	X																							
	Lockwasher	E-106-A-4	1	X	X	X																							
	Stud - Magneto Locating Dowel	T-9087	1	X	X	X																							
	Woodruff Key - Magneto Coupling	#8 Standard	1	X	X	X																							
6	Ignition Coil	M-7201	1	X	X	X																							
	Bracket - Ignition Coil	S-8747	1	X	X	X																							
	Round Head Cap Screw	1/4-20 x 1/2	2	X	X	X																							
	Plain Washer	S-9262-23	2	X	X	X																							
	Lockwasher	E-106-A-2	2	X	X	X																							
	Hex Nut	1/4-20	2	X	X	X																							
7	Oil Line	T-10278	1	X	X	X																							
	Elbow	T-9949	3	X	X	X																							
8	Oil Rage	S-8163	1	X	X	X																							
	Tee Fitting	T-9738	1	X	X	X																							
	Nipple	T-9959-1	1	X	X	X																							
	Elbow	T-9960	1	X	X	X																							
9	Welder Generator Complete	See Parts List VI	1	X	X	X	X																						
10	Oil Filter	M-6980	1	X	X	X	X																						
	Hex Head Cap Screw	5/16-18 x 5/8	2	X	X	X	X																						
	Plain Washer	S-9262-6	2	X	X	X	X																						
	Lockwasher	E-106-A-3	2	X	X	X	X																						

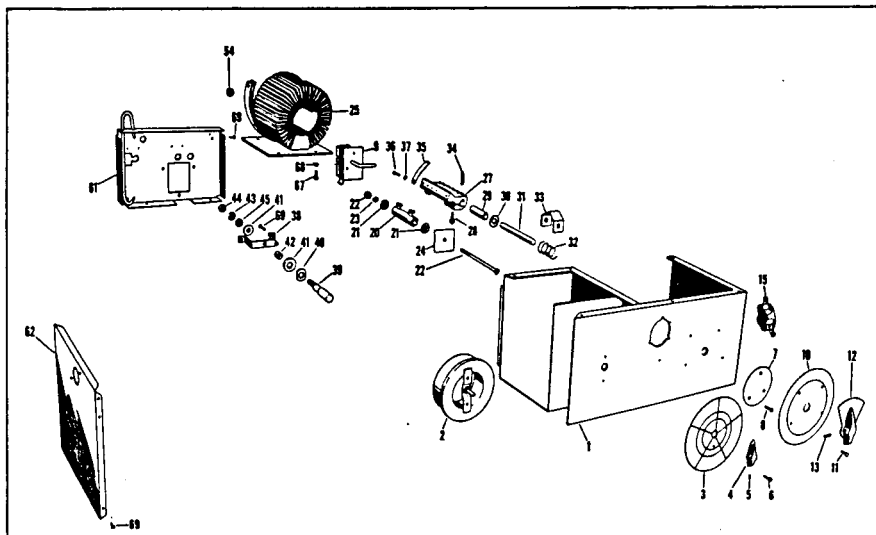

CONTROL BOX

P-22-F

PARTS LIST V FOR FIGURE V
CONTROL BOX
SAE-400 HERCULES JXD ENGINE WELDER

USE ONLY PARTS MARKED "X" IN COLUMNS BELOW
UNDER LETTER CALLED FOR IN CODE TABLE INDEX

ITEM	PART NAME AND DESCRIPTION	PART No.	REQ'D.	A	B	C	D	E	F	G	H	J	K	L	M	N	P	Q	R	S	T	U	V	W	X	Y	Z
1	Case Assembly	L-2375-A	1	X																							
2	Rheostat	M-5090-C	1	X																							
	Round Head Cap Screw - Rheostat Leads	#8-32 x 1/2	2	X																							
	Lockwasher	T-9695-3	4	X																							
	Hex Nut	#8-32	4	X																							
3	Dial Plate - For Rheostat (Voltage)	M-5735	1	X																							
4	Rheostat Handle	S-8158	1	X																							
5	Hollow Set Screw - Cup Point	#10-24 x 3/16	1	X																							
6	Round Head Cap Screw - Rheostat Mounting	#10-24 x 1/4	2	X																							
7	Reversing Switch Plate	S-6824	1	X																							
8	Self Tapping Screw - Switch Plate Mounting	S-8025-13	3	X																							
9	Reversing Switch	M-7057	1	X																							
	Hex Nut - Switch Mounting	#8-32	2	X																							
10	Dial Plate - For Reactor (Current)	M-6485	1	X																							
11	Rivet - Dial Plate Mounting	T-8973	4	X																							
12	Reactor Handle	S-7925-4	1	X																							
13	Hollow Set Screw - Half Dog Point	1/4-20 x 3/8	1	X																							
15	Receptacle	S-10571	1	X																							
20	Resistor Tube	T-8280	1	X																							
	Round Head Cap Screw - Leads	#8-32 x 5/8	2	X																							
	Hex Nut	#8-32	4	X																							
21	Centering Washer	Part of Item 20	1	X																							
22	Round Head Cap Screw - Resistor Mounting	#10-24 x 4-1/2	1	X																							
	Hex Nut	#10-24	1	X																							
23	Lockwasher	E-106-A-1	1	X																							
25	Reactor Coil Assembly	L-2036-A-1	1	X																							
	Reactor Brush Holder Assembly Includes:	M-6277	1	X																							
27	Brush Holder	M-6264	1	X																							
28	Hex Head Cap Screw	5/16-18 x 1	2	X																							
29	Insulating Tube	T-8219	1	X																							
30	Washer	T-6367	1	X																							
31	Shaft	T-8218	1	X																							
32	Spring	T-8236	1	X																							
33	Spring Clip	S-7297	1	X																							
34	Spring	T-6985	4	X																							
35	Contact	T-7494	4	X																							
36	Round Head Cap Screw	#10-24 x 3/8	4	X																							
37	Lockwasher	E-106-A-1	4	X																							
	Brush Holder Stud and Bracket Assembly Includes:	T-7852	1	X																							
38	Bracket	T-7850	1	X																							
39	Stud	T-9107	1	X																							
40	Copper Washer	T-8485	1	X																							
41	Insulating Washer	S-10773-9	2	X																							
42	Insulating Bushing	T-5411	1	X																							
43	Lockwasher	E-106-A-5	1	X																							
44	Hex Jam Nut	T-10114	1	X																							
45	Plain Washer	S-9262-1	1	X																							
54	Hex Jam Nut - Reactor Lead Mounting	T-10114	1	X																							
61	Sub Panel	L-2294-1	1	X																							
62	End Cover	M-5942	1	X																							
67	Round Head Cap Screw - Reactor Mounting	1/4-20 x 1/2	4	X																							
68	Lockwasher - Reactor Mounting	E-106-A-2	4	X																							
69	Self Tapping Screw - End Cover to Sub Panel	S-8025-17	4	X																							
	Square Head Cap Screw - Control Box to Rail	3/8-16 x 1	4	X																							
	Plain Washer	S-9262-4	4	X																							
	Lockwasher	E-106-A-4	4	X																							
	Square Nut	3/8-16	4	X																							

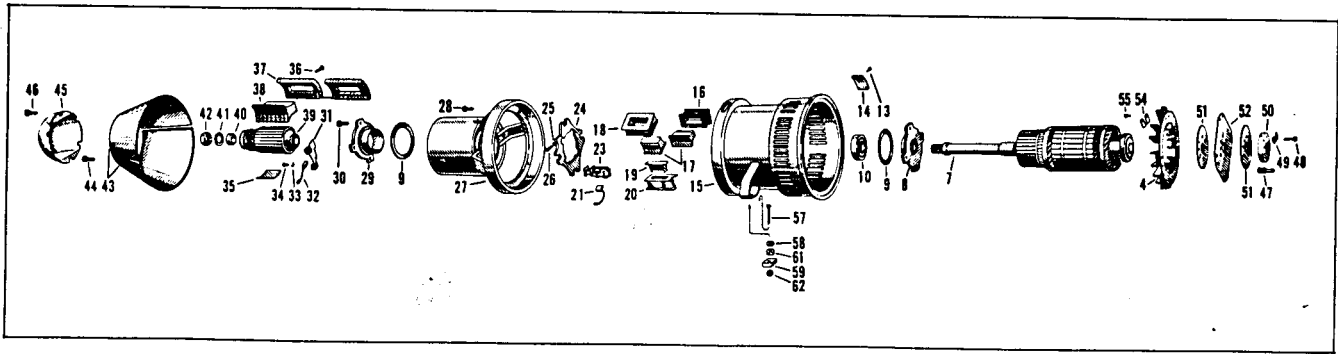

GENERATOR

P-22-G

PARTS LIST VI FOR FIGURE VI
GENERATOR
SAE-400 HERCULES JXD ENGINE WELDER

USE ONLY PARTS MARKED "X" IN COLUMNS BELOW
UNDER LETTER CALLED FOR IN CODE TABLE INDEX

ITEM	PART NAME AND DESCRIPTION	PART No.	REQ'D.	A	B	C	D	E	F	G	H	J	K	L	M	N	P	Q	R	S	T	U	V	W	X	Y	Z
4	Blower Fan	M-6729	1		X	X																					
7	Armature Assembly Includes:	L-2667-12	1			X																					
7	Armature Assembly Includes:	L-2667-14	1			X																					
	Armature Coil Set	See Code Table Index	1		X	X																					
	Shaft	M-6998	1		X																						
	Shaft	M-7531	1			X																					
	Commutator	M-6995	1		X	X																					
8	Inner Dust Cap	S-7800	1		X																						
9	Gasket - Dust Cap	T-3633-11	2		X																						
10	Ball Bearing	#310	1		X	X																					
13	Drive Screw	S-8025-8	2		X	X																					
14	Name Plate	T-8293	1		X	X																					
15	Generator Frame	M-6528-1	1		X	X																					
16	Series Field Coil	See Code Table Index	2		X	X																					
17	Main Pole Piece	S-10745-7	4		X	X																					
18	Shunt Field Coil	See Code Table Index	2		X	X																					
	Interpole Coil and Pole Assembly Includes:	S-5086	4		X	X																					
19	Interpole Piece	S-10748-1	4		X	X																					
20	Interpole Coil	See Code Table Index	4		X	X																					
21	Brush - Generator	T-6085	12		X	X																					
23	Brush Holder - Generator	See Parts List VII	4		X	X																					
24	Rocker	S-5960	1		X	X																					
25	Lockwasher	E-106-A-2	1		X	X																					
26	Round Head Cap Screw	5/16-18 x 2	1		X	X																					
27	End Bracket	M-5588	1		X																						
27	End Bracket	M-7519-2	1		X																						
28	Hex Head Cap Screw	1/2-13 x 1-3/4	4		X	X																					
29	Outer Dust Cap	S-7799	1		X																						
30	Hex Head Cap Screw	5/16-18 x 3-1/2	2		X																						
31	Exciter Brush Holder Assembly Includes:	S-6531-A	2		X																						
	Spring	T-6887	2		X																						
	Insulation Tube	T-8167	4		X																						
	Insulation Washer	T-7626	8		X																						
	Hex Nut	#10-24	2		X																						
32	Brush - Exciter	T-6968	2		X																						
33	Plain Washer	S-9262-23	4		X																						
34	Thread Cutting Screw - Brush Holder Mounting	S-9225-1	4		X																						
35	Lead Shield - Exciter Leads	T-9100	1		X																						
36	Hex Head Cap Screw	5/16-18 x 1-1/4	4		X																						
37	Exciter Field Coil Set	See Code Table Index	1		X																						
38	Exciter Pole Piece	M-8774-1	2		X																						
39	Exciter Armature Assembly Includes:	M-4047	1		X																						
	Exciter Armature Coil Set	See Code Table Index	1		X																						
40	Exciter Sleeve Collar	T-5345	1		X																						
41	Exciter Washer	T-7090-1	1		X																						
42	Exciter Nut	T-6225-1	1		X																						
43	Bracket Cover	M-5584	1		X	X																					
44	Thread Cutting Screw	S-9225-2	3		X	X																					
45	Exciter Cover	L-2594	1		X																						
46	Thread Cutting Screw	S-9225-2	2		X																						
47	Stud - In Flywheel	T-8906	4		X																						
48	Screw - Disc to Hub	T-8833-2	8		X	X																					
49	Locking Clip - Inner	T-9450	4		X	X																					
50	Clamping Ring	S-7803	1		X	X																					
51	Disc Backing Plate	S-8042	2		X	X																					
52	Coupling Disc	M-6730	1		X	X																					
54	Locking Clip - Outer	T-9049	4		X	X																					
55	Screw - Disc to Flywheel	T-8833-1	8		X	X																					
57	Square Head Cap Screw - Welder Mounting	1/2-13 x 1-1/2	2		X	X																					
58	Plain Washer	S-9262-1	4		X	X																					
61	Lockwasher	E-106-A-5	2		X	X																					
62	Square Nut	1/2-13	2		X	X																					
	Lead Insulation Block	T-7001	1		X	X																					
	Self Tapping Screw - Block Mounting	S-8025-7	4		X	X																					
	Hex Head Cap Screw - Generator to Engine	1/2-13 x 1-1/2	4		X	X																					
	Lockwasher	E-106-A-5	4		X	X																					
	Pipe Plug - Grease Hole	1/8 Standard	1		X																						

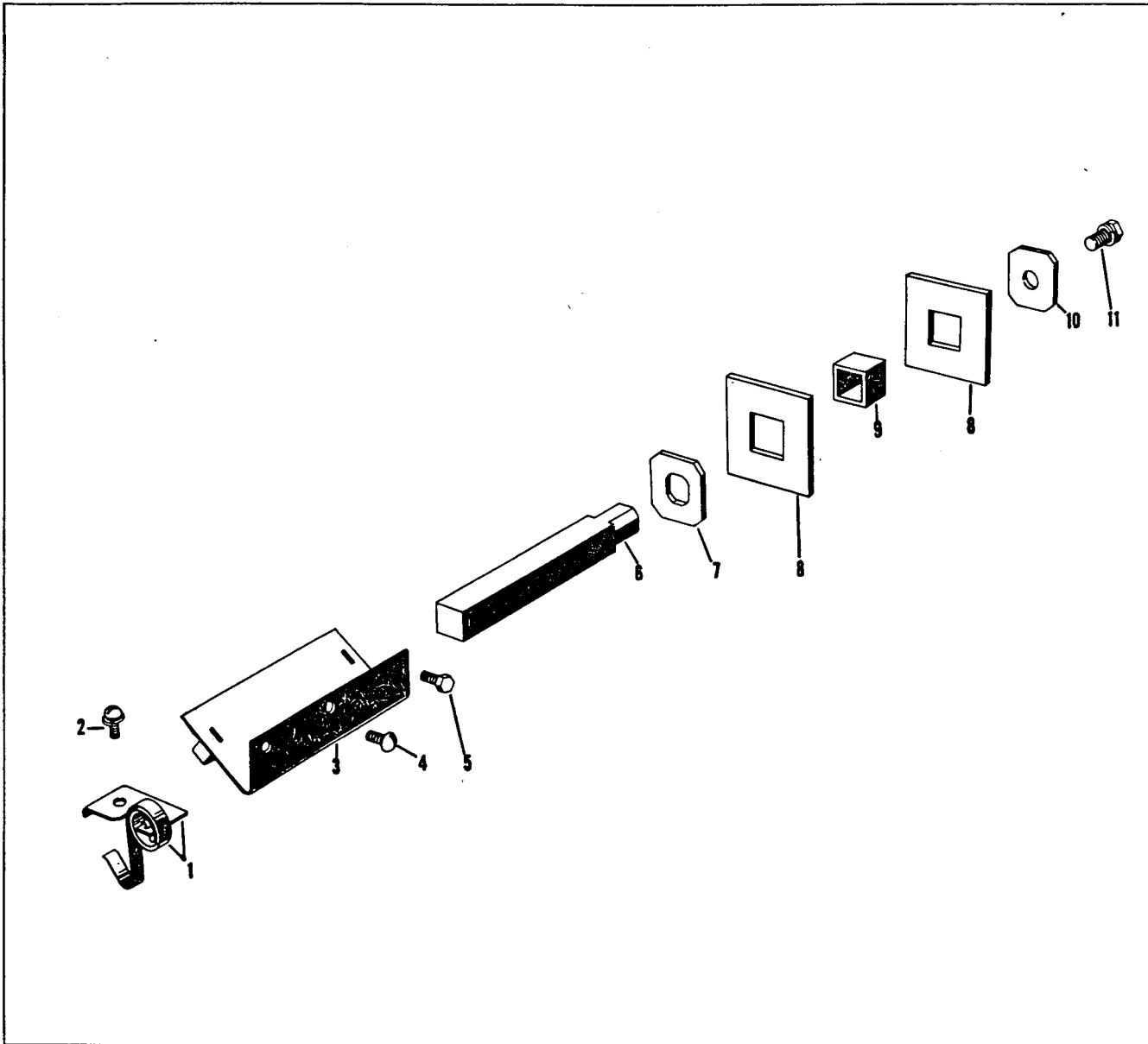

BRUSH HOLDER

PARTS LIST VII FOR FIGURE VII
BRUSH HOLDER
SAE-400 HERCULES JXD ENGINE WELDER

P-22-H

USE ONLY PARTS MARKED "X" IN COLUMNS BELOW
UNDER LETTER CALLED FOR IN CODE TABLE INDEX

ITEM	PART NAME AND DESCRIPTION	PART No.	REQ'D.	A	B	C	D	E	F	G	H	J	K	L	M	N	P	Q	R	S	T	U	V	W	X	Y	Z
1	Brush Holder Assembly Includes: Spring and Clip Assembly	N-6964-12-A T-8495	4 12	x																							
2	Round Head Cap Screw	T-10107-1	4	x																							
3	Plate and Retainer Assembly	N-6304-12-B	4	x																							
4	Round Head Cap Screw	5/16-18 x 1/2	8	x																							
5	Hex Head Cap Screw	5/16-18 x 1/2	4	x																							
6	Stud	N-6963-7	4	x																							
7	Washer	T-9020	4	x																							
8	Insulating Washer	T-4479	8	x																							
9	Insulating Tube	T-1450	4	x																							
10	Washer	T-2414	4	x																							
11	Hex Head Cap Screw	T-10106-1	4	x																							

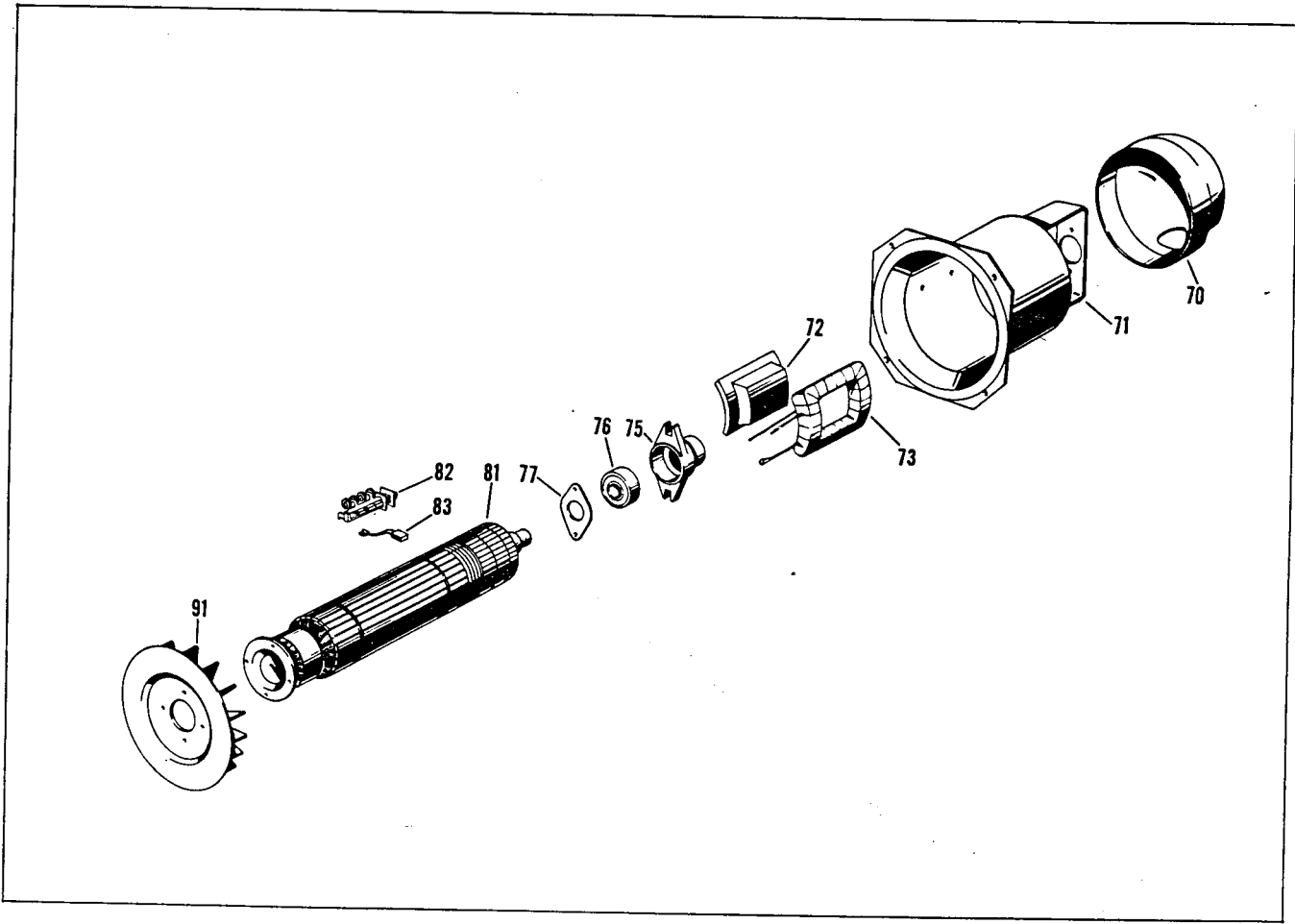

FDR EXCITER

PARTS LIST VIII FOR FIGURE VIII FOR EXCITER SAE-400 HERCULES JXD ENGINE WELDER				USE ONLY PARTS MARKED "X" IN COLUMNS BELOW UNDER LETTER CALLED FOR IN CODE TABLE INDEX																									
ITEM	PART NAME AND DESCRIPTION	PART No.	REQ'D.	A	B	C	D	E	F	G	H	I	J	K	L	M	N	P	Q	R	S	T	U	V	W	X	Y	Z	
70	End Cover	M-7087	1		X	X																							
	Round Head Cap Screw	#10-24 x 1/2	2		X	X																							
	Lockwasher	E-106-A-1	2		X	X																							
71	Frame	L-2536	1		X	X																							
	Hex Head Cap Screw - Frame Mounting	3/8-16 x 3/4	4		X	X																							
	Lockwasher	E-106-A-4	4		X	X																							
72	Main Pole Piece Only	M-8773-3	2		X	X																							
73	Main Pole Coil Only	See Code Table Index	2		X	X																							
	Hex Head Cap Screw - Main Pole Mounting	3/8-16 x 1-1/4	4		X	X																							
75	Bearing Cage	M-7500	1		X	X																							
	Pipe Plug	S-10780-3	1		X	X																							
76	Ball Bearing	MRC #204	1		X	X																							
77	Bearing Cage Clamping Ring	T-9720	1		X	X																							
	Round Head Cap Screw - Cage Mounting	1/4-20 x 1-3/8	2		X	X																							
	Lockwasher	E-106-A-2	2		X	X																							
81	Armature Complete Assembly Includes:	M-7520	1		X	X																							
	Armature Without Commutator and Windings	M-7520-A	1		X	X																							
	Commutator	T-8119	1		X	X																							
	Armature Coil Set	See Code Table Index	1		X	X																							
82	Brush Holder	See Parts List IX	2		X																								
83	Brushes	See Parts List X	2		X																								
91	Coupling Blower	T-7554	4		X	X																							
	Hex Head Cap Screw	M-6738	1		X	X																							
	Screw Clip	T-9150	6		X	X																							
	Extension Key	S-8156	3		X	X																							
	Hollow Set Screw - Cup Point	M-8776-14	1		X	X																							
	Hollow Set Screw - Cup Point	5/16-18 x 3/8	1		X	X																							
	Hollow Set Screw - Cup Point	5/16-18 x 3/4	1		X	X																							

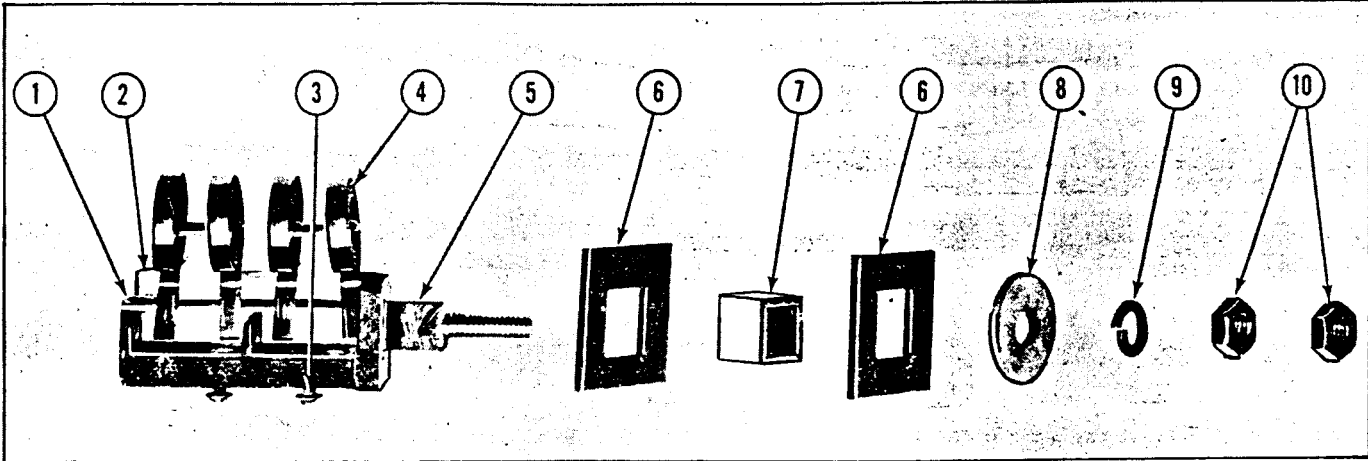

FDR BRUSH HOLDER

PARTS LIST IX FOR FIGURE IX FDR BRUSH HOLDER SAE-400 HERCULES JXD ENGINE WELDER					USE ONLY PARTS MARKED "X" IN COLUMNS BELOW UNDER LETTER CALLED FOR IN CODE TABLE INDEX																									
ITEM	PART NAME AND DESCRIPTION	PART No.	REQ'D.	A	B	C	D	E	F	G	H	J	K	L	M	N	P	Q	R	S	T	U	V	W	X	Y	Z			
	Brush Holder Assembly Includes:	S-6710-A	2	X																										
	Brush Holder Assembly Includes:	S-6711-A	2	X																										
	Brush Holder Assembly Includes:	S-6711-B	2	X																										
1	Rivet	T-5576-18	4	X																										
1	Rivet	T-5576-19	4	X																										
2	Spring Clip	S-6709	2	X																										
3	Round Head Cap Screw	#10-24 x 1/4	4	X																										
4	Spring	T-6887	8	X																										
4	Spring	T-6887	4	X																										
5	Brush Holder Stud	S-6707	2	X																										
5	Brush Holder Stud	S-6708	2	X																										
6	Insulating Washer	T-7976	4	X																										
7	Insulating Bushing	T-1531	2	X																										
8	Plain Washer	S-9267-87	2	X																										
9	Lockwasher	F-106-A-4	2	X																										
10	Hex Jam Nut - Brass	3/8-16	4	X																										

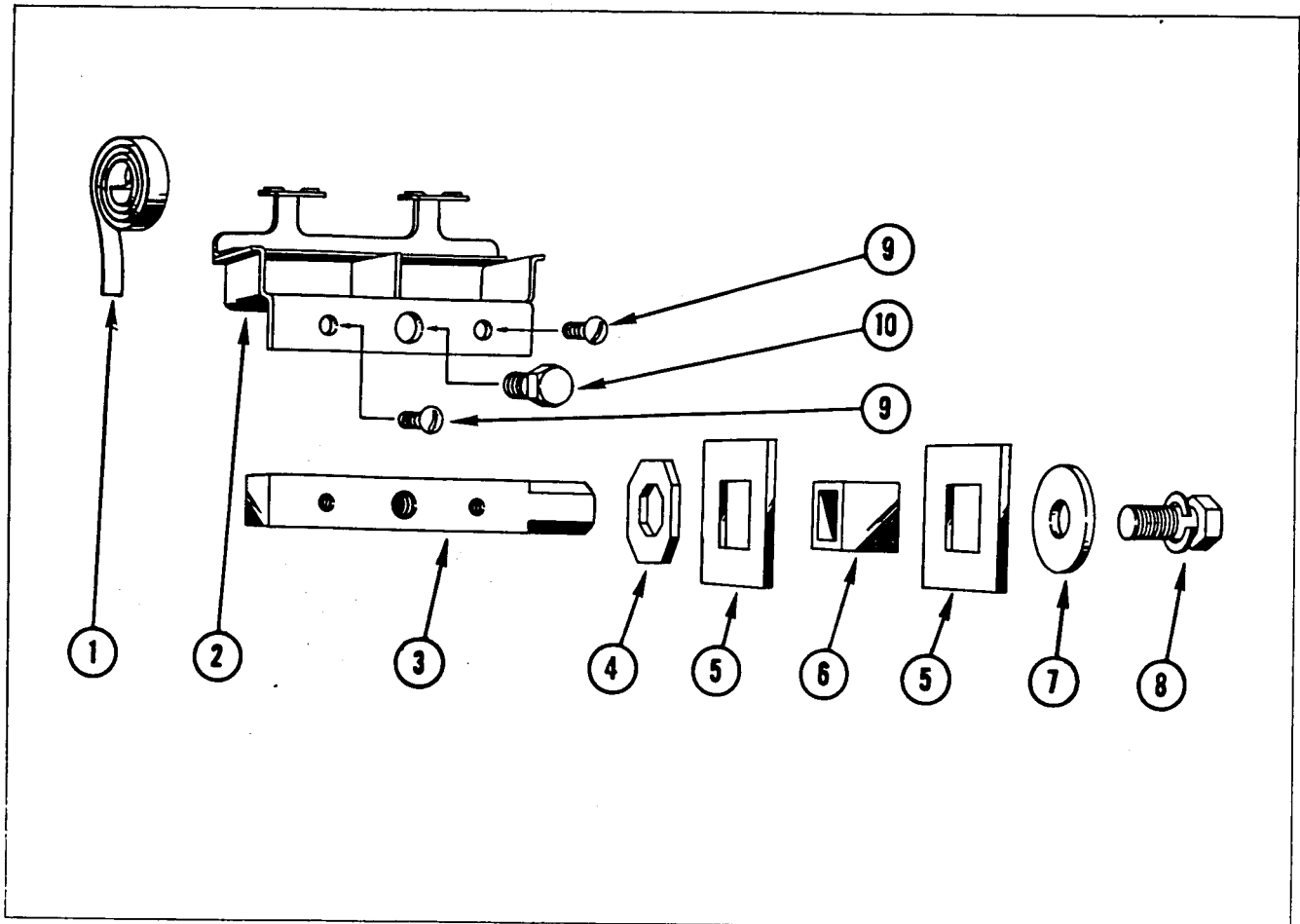

BRUSH HOLDER

PARTS LIST X FOR FIGURE X BRUSH HOLDER SAE-400 HERCULES JXD ENGINE WELDER				USE ONLY PARTS MARKED "X" IN COLUMNS BELOW UNDER LETTER CALLED FOR IN CODE TABLE INDEX																									
ITEM	PART NAME AND DESCRIPTION	PART No.	REQ'D.	A	B	C	D	E	F	G	H	J	K	L	M	N	P	Q	R	S	T	U	V	W	X	Y	Z		
	Brush Holder Assembly Includes:	S-9561-A	2	x																									
	Brush Holder Assembly Includes:	S-9562-A	2	x																									
	Brush Holder Assembly Includes:	S-9562-C	2	x																									
1	Spring	T-6887	8	x																									
1	Spring	T-6887	4	x																									
2	Brush Holder Bracket	S-9560-1	2	x																									
2	Brush Holder Bracket	S-9560-2	2	x																									
3	Stud	S-9558	2	x																									
4	Stud Washer	T-10262	2	x																									
5	Insulating Washer	T-7976	4	x																									
6	Insulating Bushing	T-1531	2	x																									
7	Plain Washer	S-9262-47	2	x																									
8	Semi Hex Head Cap Screw	T-10106-1	2	x																									
9	Round Head Cap Screw	#10-24 x 3/8	4	x																									
10	Hex Head Cap Screw	5/16-18 x 1/2	2	x																									

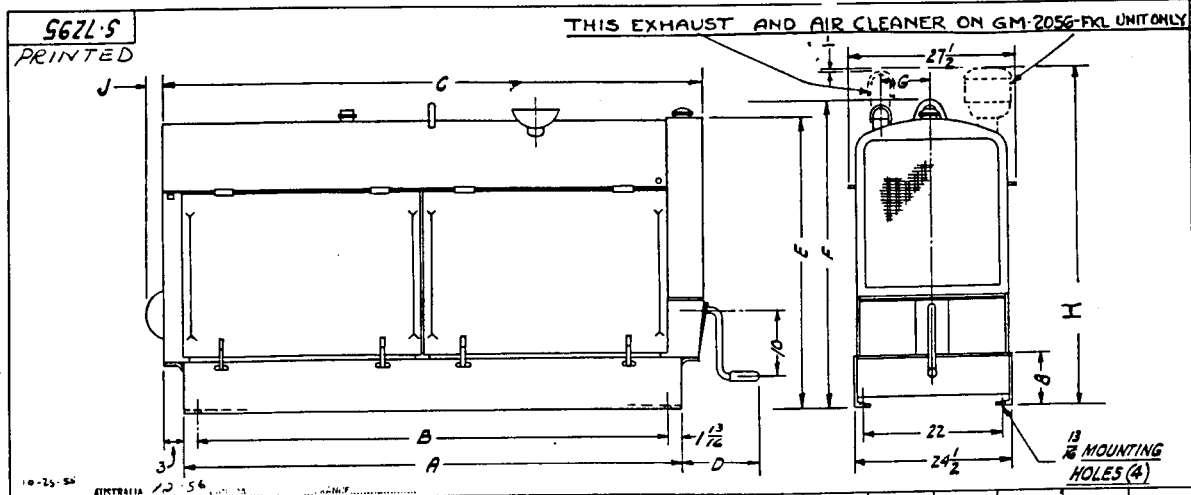

CONT. F-244 FKL	300	1400	76 ⁷ / ₈	73 ¹ / ₄	84 ⁵ / ₈	11 ⁵ / ₈	43 ⁷ / ₈	48	9 ¹ / ₄			
JXLD-FMS-FDW	600	1400	76 ⁷ / ₈	73 ¹ / ₄	84 ⁵ / ₈	11 ⁵ / ₈	43 ⁷ / ₈	48 ¹ / ₂	7 ⁹ / ₁₆	3		
CONTINENTAL-F-226-FKL	300	1400	76 ⁷ / ₈	73 ¹ / ₄	84 ⁵ / ₈	11 ⁵ / ₈	43 ⁷ / ₈	48 ¹ / ₂	9 ¹ / ₁₆			
HERCULES QXLD-FKL	300	1400	76 ⁷ / ₈	73 ¹ / ₄	84 ⁵ / ₈	11 ⁵ / ₈	43 ⁷ / ₈	48 ¹ / ₂	7 ⁹ / ₁₆			
GM-2056-FKL	300 400		76 ⁷ / ₈	73 ¹ / ₄	84 ⁵ / ₈		43 ⁷ / ₈	48 ¹ / ₂	8	53 ¹ / ₄		(NO ENGINE CRANK ON THIS JOB)
HERCULES JXD(STUDE) FLW	400	1400	76 ⁷ / ₈	73 ¹ / ₄	84 ⁵ / ₈	11 ⁵ / ₈	43 ⁷ / ₈	48 ¹ / ₂	7 ⁹ / ₁₆			
HERCULES JXD(STUDE) FKL	300	1400	76 ⁷ / ₈	73 ¹ / ₄	84 ⁵ / ₈	11 ⁵ / ₈	43 ⁷ / ₈	48 ¹ / ₂	7 ⁹ / ₁₆			
TYPE	AMP.	RPM	A	B	C	D	E	F	G	H	J	

THE LINCOLN ELECTRIC CO.
CLEVELAND, OHIO USA
DATE 5-23-44 SCALE 1/8" SIZE

5-18-45-1 10-28-55
6-22-45 11-19-54
1-30-48 C
10-15-48
6-9-50 D
9-19-52 D

TYPE ENGINE DRIVEN WELDERS
SUBJECT DIMENSION PRINT
SUPSOG. DRG. DR. CHK. DRG. 5-7295

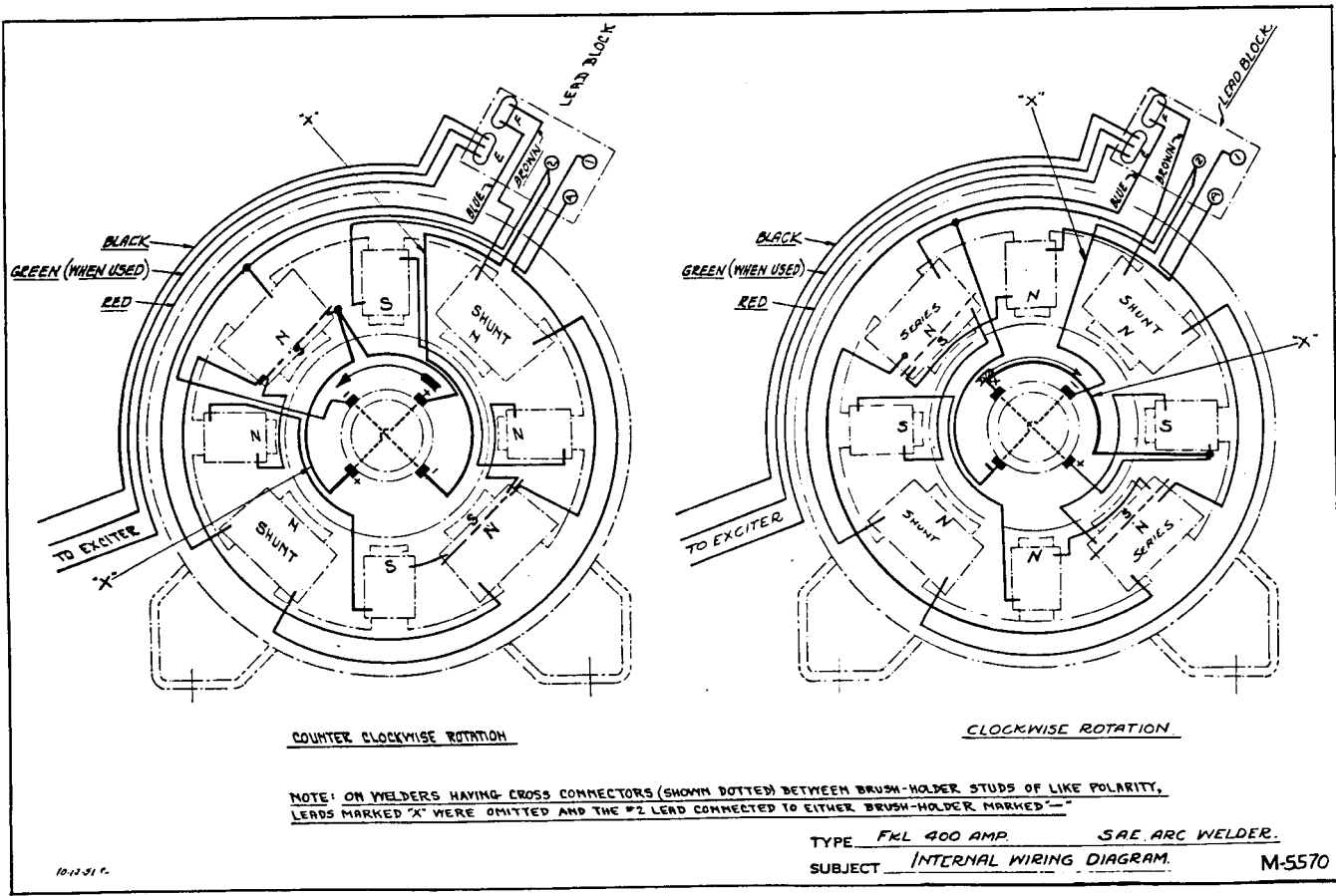

SERVICE

The Lincoln Electric Company has Authorized Field Service Shops in all industrial centers in the United States, Canada, Cuba, Hawaii and Alaska. These shops stock GENUINE Lincoln Replacement Parts and have Factory Trained men to service your welder. They also offer Preventive Service and Welder Rental to "Keep Them Welding". The Lincoln FSS Exchange Plans, extended only through the FSS give you factory built and guaranteed STATORS, ARMATURES and other parts at material savings over rewinding.

HOW TO ORDER REPLACEMENT PARTS

In ordering replacement parts, give the following information from the nameplate - serial number, code number and name and model of welding machine. If possible give part name and number. Parts should be ordered from The Lincoln Electric Co., its branch offices, or the nearest Authorized Field Service Shop. (The "Lincoln Service Directory" listing these shops geographically is available on request.) All Authorized Field Service Shops and branch offices can quote current prices for these replacement parts.

-- BUY ONLY GENUINE LINCOLN REPLACEMENT PARTS --

REMANUFACTURING

After your welder has provided many years of trouble-free service, Lincoln provides a remanufacturing service whereby a welder may be returned to the factory and completely rebuilt. The unit is completely disassembled and rebuilt so that all electrical and mechanical parts are returned to original new-welder performance standards, new parts being used wherever necessary.

"Lincolnditioning" as this service is called, enables you to choose the time when you want your welders to be overhauled, before costly breakdowns and costly waiting for replacement parts occur when the welder is on the job.

A new welder guarantee is issued with each remanufactured welder. This assures another full service life from your welder at less than half the cost of a new unit. Contact your nearest Lincoln welding engineer for full details.

The Lincoln Electric Company, the Seller, warrants all new equipment except engines and accessories thereof, against defects in workmanship and material for a period of one year from date of shipment, provided the equipment has been properly cared for and operated under normal conditions. Engines and engine accessories are warranted free from defects for a period of ninety days from the date of shipment.

If the Buyer gives the Seller written notice of any defect in equipment or electrode within any period of warranty and the Seller's inspection confirms the existence of such defects, then the Seller shall correct the defect or parts at its option, either by repair or replacement F.O.B. its own factory or other place as designated by the Seller.

No expense liability or responsibility will be assumed by the Seller for repairs made outside of the Seller's factory without written authority from the Seller.

The Seller shall not be liable for any consequential damages in case of any failure to meet the conditions of any warranty. The liability of the Seller arising out of the supplying of said equipment or electrode or its use by the Buyer whether on warranties or otherwise, shall not in any case exceed the cost of correcting defects in the equipment or replacing defective electrode in accordance with the above guarantee. Upon the expiration of any period of warranty, all such liability shall terminate.

The foregoing guarantees and remedies are exclusive and there are no other guarantees or warranties either expressed or implied.

THE LINCOLN ELECTRIC COMPANY

The World's Largest Manufacturer of Arc Welding Equipment

CLEVELAND 17, OHIO

Branch Offices, Field Service Shops, and Distributing Agencies in All Principal Cities

LINCOLN ELECTRIC CO., of Canada, Ltd., Leaside, Toronto 12, Canada

LINCOLN ELECTRIC CO., (Australia) Pty., Ltd., Alexandria, Sydney

LA SOUDURE ELECTRIQUE LINCOLN, Bonneuil-sur-Marne, (Seine), France.

Export Representatives

THE ARMCO INTERNATIONAL CORPORATION, Chrysler Bldg., New York 17, New York
Middletown, Ohio, U.S.A.

THE
MUSEUM OF
ART AND
ARCHITECTURE
OF THE
CITY OF
NEW YORK
AND
THE
METROPOLITAN MUSEUM OF ART