

K3589-1 - RANGER FACTORY UNDERCARRIAGE

REQUIRED TOOLS

- 9/16" Wrench and Socket
- 1/2" Wrench and Socket
- Ratchet
- TORX T-30 Bit or Driver
- Grease Gun
- Hammer or Mallet
- Crane or Hoist

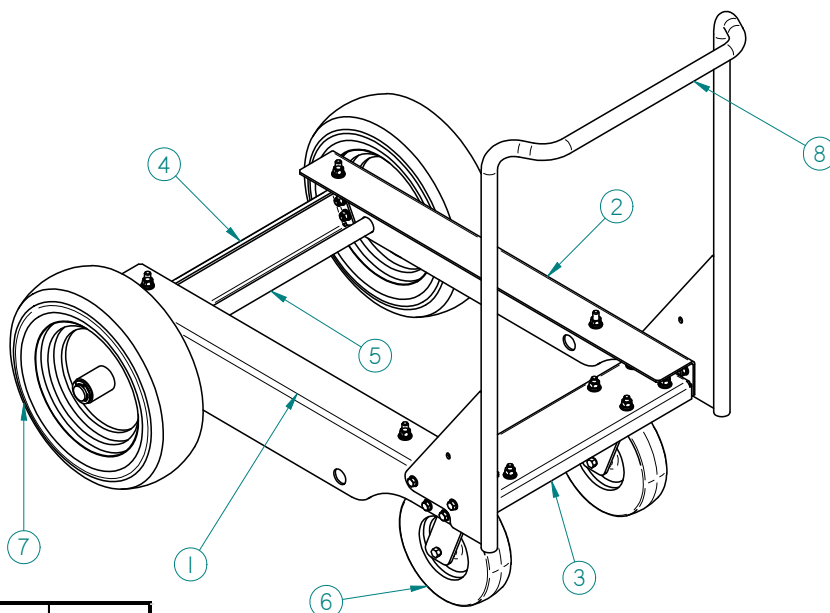

PARTS INCLUDED

ITEM	PART NO.	DESCRIPTION	QTY.
1	L17286	SIDE RAIL	1
	T8833-86	3/8-16 X 1.25" HEX HEAD CAP SCREW	2
	CF000067	3/8-16 HEX NUT	2
	S9262-120	3/8" PLAIN WASHER	4
	E106A-16	3/8" LOCK WASHER	2
2	L17287	SIDE RAIL	1
	T8833-86	3/8-16 X 1.25" HEX HEAD CAP SCREW	2
	CF000067	3/8-16 HEX NUT	2
	S9262-120	3/8" PLAIN WASHER	4
	E106A-16	3/8" LOCK WASHER	2
3	L17288	FRONT CROSSMEMBER	1
	S24739-43	5/16-18 X .75" HEX HEAD CAP SCREW	4
	CF000029	5/16-18 HEX NUT	4
	S9262-121	5/16" PLAIN WASHER	4
	E106A-14	5/16" LOCK WASHER	4
4	L17289	REAR CROSSMEMBER	1
	S24739-43	5/16-18 X .75" HEX HEAD CAP SCREW	4
	CF000029	5/16-18 HEX NUT	4
	S9262-121	5/16" PLAIN WASHER	4
	E106A-14	5/16" LOCK WASHER	4
5	M26317	AXLE SHAFT	1
6	M26562-1	CASTER WHEEL	2
	T8833-86	3/8-16 X 1.25" HEX HEAD CAP SCREW	8
	CF000067	3/8-16 HEX NUT	8
	S9262-120	3/8" PLAIN WASHER	16
	E106A-16	3/8" LOCK WASHER	8
7	S32770	PNEUMATIC WHEEL	2
	S32843	E-CLIP	2
	S9262-24	1" PLAIN WASHER	2
8	G9190	HANDLE ASSEMBLY	1
	S24739-43	5/16-18 X .75" HEX HEAD CAP SCREW	4
	CF000029	5/16-18 HEX NUT	4
	S9262-121	5/16" PLAIN WASHER	4
	E106A-14	5/16" LOCK WASHER	4

⚠ WARNING

FALLING EQUIPMENT can cause injury.

- Lift only with equipment of adequate lifting capacity.
- Be sure machine is stable when lifting.



MOVING PARTS can injure.

- Stop engine before installation.
- Assemble on level ground.
- Push only from the front using the Undercarriage handle.



⚠ CAUTION

- Wear safety glasses in work area at all times.

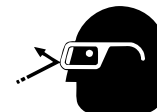

INSTALLATION OF THE UNDERCARRIAGE

Step 1: Front Wheels

- a. Using a 9/16" wrench and socket, assemble the caster wheels to the front crossmember (L17288). Use (8) 3/8-16 x 1.25" hex head cap screw, (8) 3/8-16 hex nuts, (8) 3/8" plain washers, and (8) 3/8" lock washers. Torque 3/8-16 bolts to 15 ft-lbs.

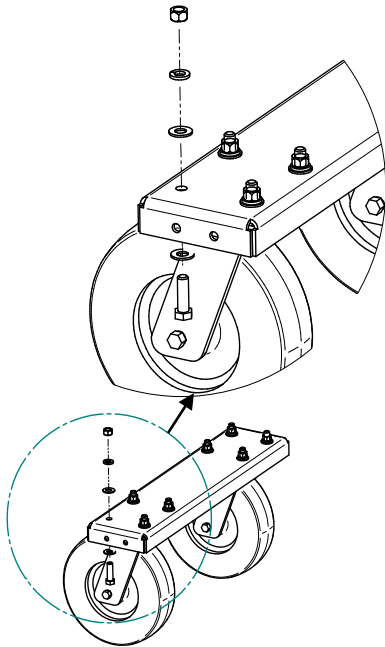

Step 2: Front Crossmember

- a. Loosely install the front cross member (L17288) to the two side rails (L17286 & L17287). Use (4) 5/16-18 x 1.00 hex head cap screw, (4) 5/16-18 hex nuts, (4) 5/16" plain washers, and (4) 5/16" lock washers. Leave bolted connections finger tight.

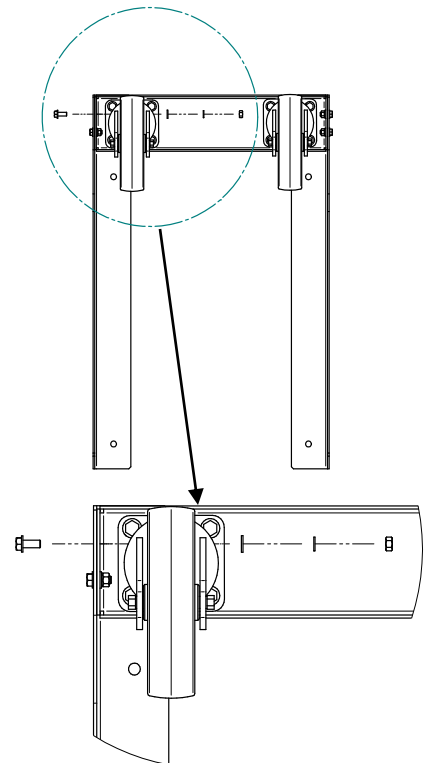
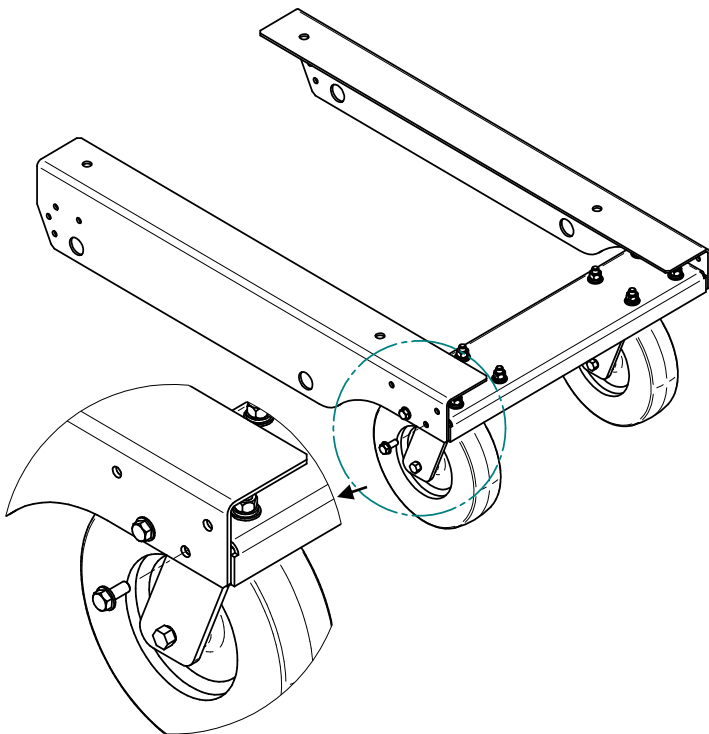

Step 3: Rear Crossmember

- a. Using a 1/2" wrench and socket, install the rear crossmember (L17289) to the two side rails (L17286 & L17287). Use (4) 5/16-18 x 1.00 hex head cap screw, (4) 5/16-18 hex nuts, (4) 5/16" plain washers, and (4) 5/16" lock washers. Tighten all bolts on front and rear crossmember now. Torque 5/16-18 bolts to 8 ft-lbs.

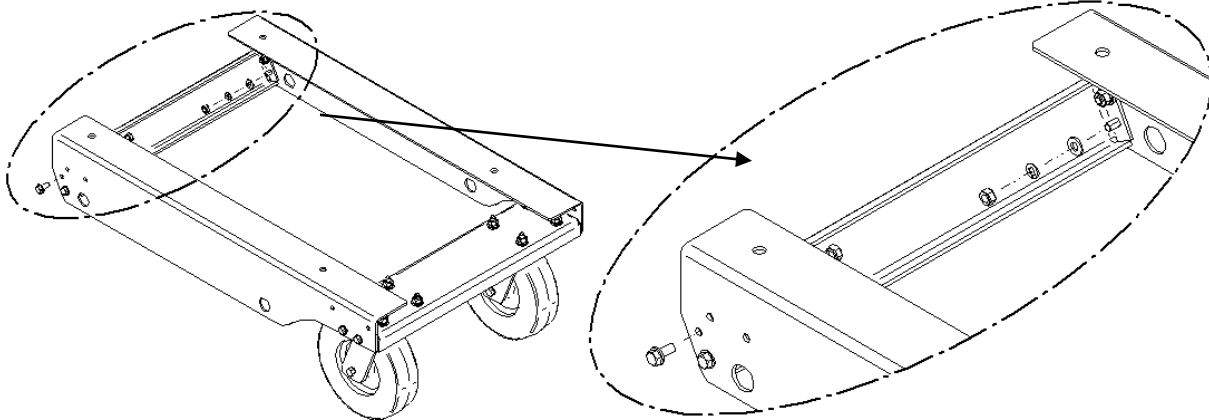

Step 4: Axle and Back Wheels

- a. Slide axle shaft (M26317) through the side rails holes.
- b. Push a wheel onto each end of the axle shaft with the longer hub oriented toward the side rail, and the air valve hub side facing out.
- c. Place a 1" washer on each axle end and then attach an E-Clip to each end of the axle shaft to hold the wheels in place.
- d. Grease each wheel hub with grease gun.

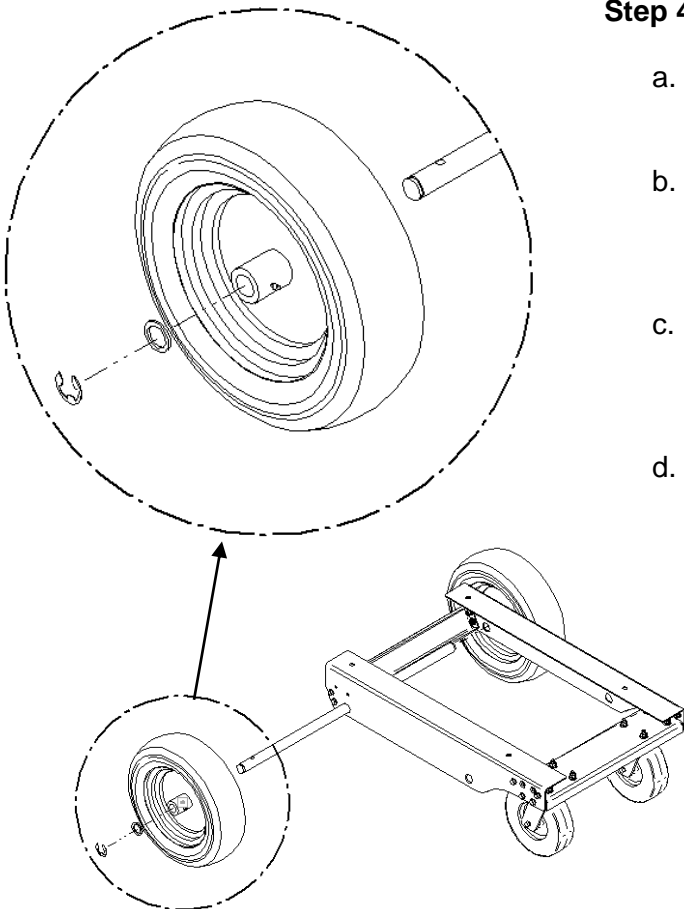

Step 5: Bolting Machine to Undercarriage

- a. Place the machine on the undercarriage with crane or hoist, aligning the (4) holes on the bottom of the machine with the (4) holes on the cart. The side doors will need to be removed to see the front (2) holes on the machine.
- b. Using a 9/16" wrench and socket, assemble the undercarriage to the machine using the (2) holes on each side rail. Use (4) 3/8-16 x 1.25" hex head cap screw, (4) 3/8-16 hex nuts, (8) 3/8" plain washers, and (4) 3/8" lock washers. Torque 3/8-16 bolts to 15 ft-lbs.

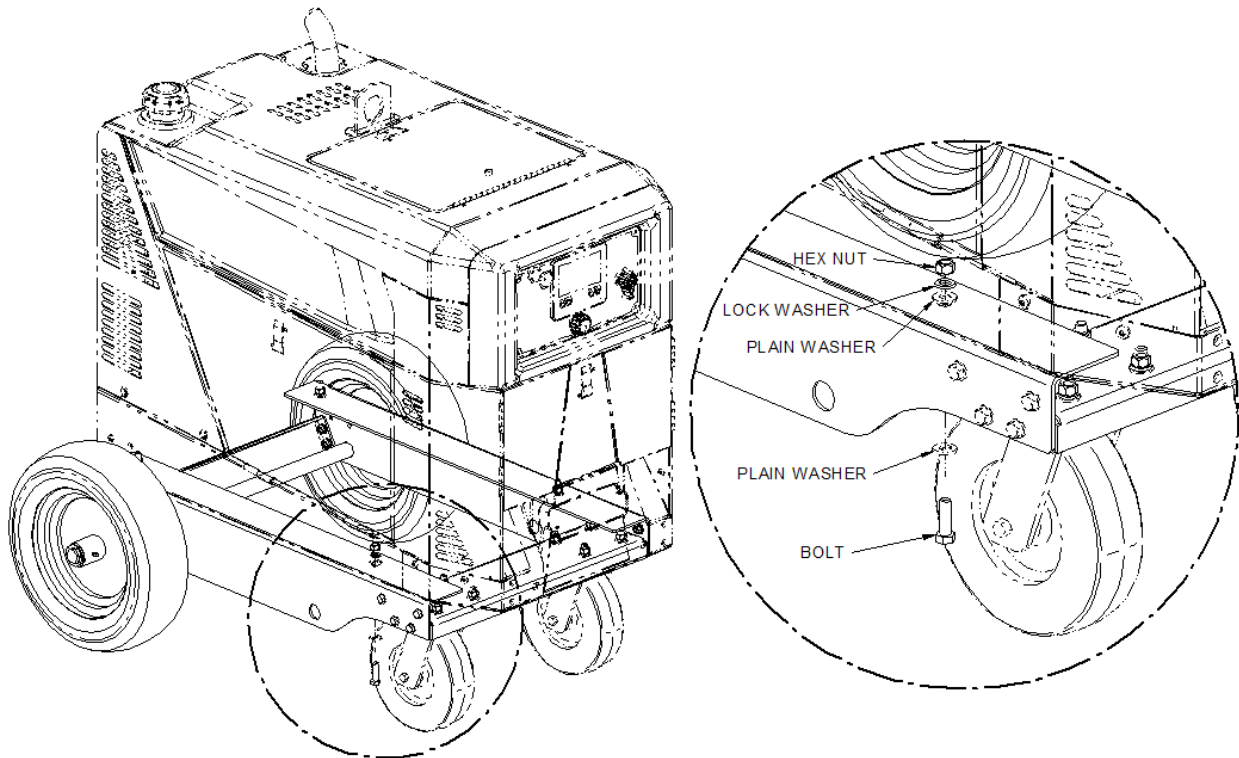
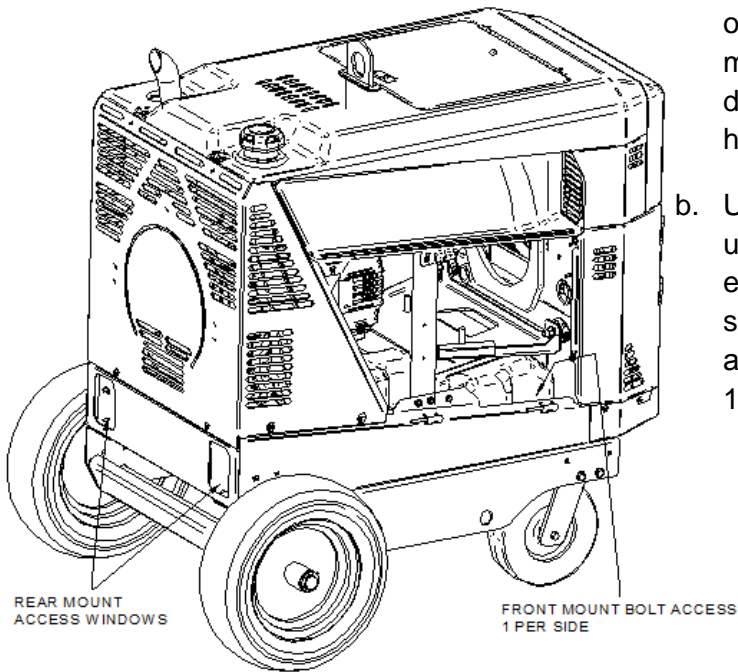

Step 6: Installing the Handle

- Remove (2) 1/4-20 x .50" pan head screws using a T30 bit from the front left and front right sides of the welder. Keep these screws for Step 6 c.
- Using a 1/2" wrench and socket, install the handle assembly (G9190) to the two side rails (L17286 & L17287). Use (4) 5/16-18 x 1.00" hex head cap screw, (4) 5/16-18 Hex nuts, (4) 5/16" plain washers, and (4) 5/16" Lock washers inserted into the bottom two holes. Leave loose until after step 6 c.
- Insert the (2) 1/4-20 x .50" pan head screws (from Step 6 a.), using a T30 bit, through the remaining 1/4" hole on each side of the undercarriage handle mount. Torque 1/4-20 pan head screws to 50 in-lbs and 5/16-18 bolts to 8 ft-lbs.

Step 6 a.

