

OMNICLEAN

ROBOTIC GRINDING SYSTEMS

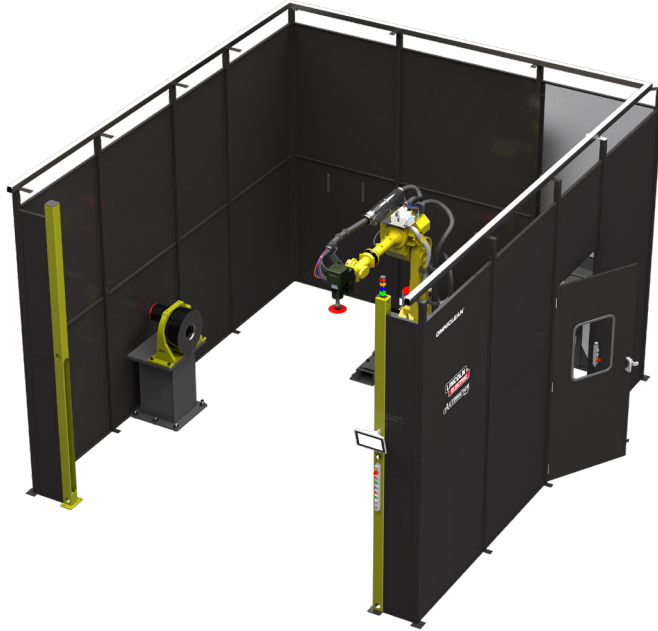

OmniClean FHS system

Renders are for reference only

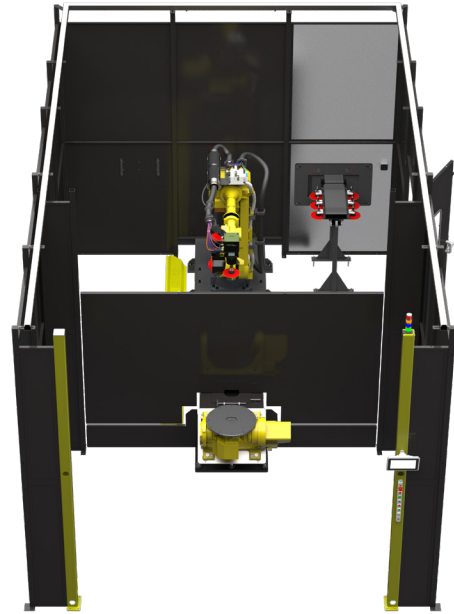

OmniClean XFT-TR system

OMNICLEAN ROBOTIC GRINDING SYSTEMS

Automating your weld grinding process is now easier than ever with the OmniClean® robotic grinding systems. Robotic grinding takes the guesswork and strain out of the equation for repetitive, precise pre- and post-weld processes. The new standard models are designed to offer you flexible options without compromising on price!

SYSTEM INCLUDES

- FANUC® robot
- Pushcorp® rotary tool
- Pushcorp active compliant tool
- 3M® abrasives starter pack
- Cool Arc® 55 water cooler
- Cell guarding
- FANUC programming software

BENEFITS

- Integrated safety measures
- Minimal installation required
- Pre-engineered designs
- Application engineering support

INDUSTRIES

- Metal fabrication
- General fabrication
- Low-mix, high-volume job shop

OPTIONS AVAILABLE

- Media change drawer
- Positioner type
- Integrated human-machine interface (HMI)
- PRISM® air filtration system

CONTACT LINCOLN ELECTRIC AUTOMATION - COLUMBUS



1700 Jetway Blvd
Columbus, OH 43219



+1 (614) 471-5926



lincolnelectric.com/omniclean

Publication LEA-032725TM1-02

© Lincoln Global Inc. All Rights Reserved All trademarks and registered trademarks are the property of their respective owners.
www.lincolnelectric.com/automation



SYSTEM LAYOUTS

OmniClean FHS system

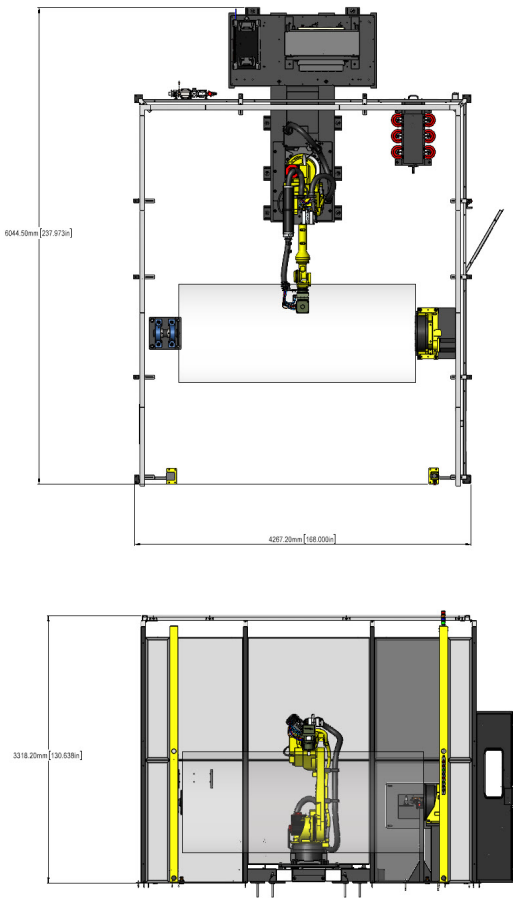

OmniClean FW system

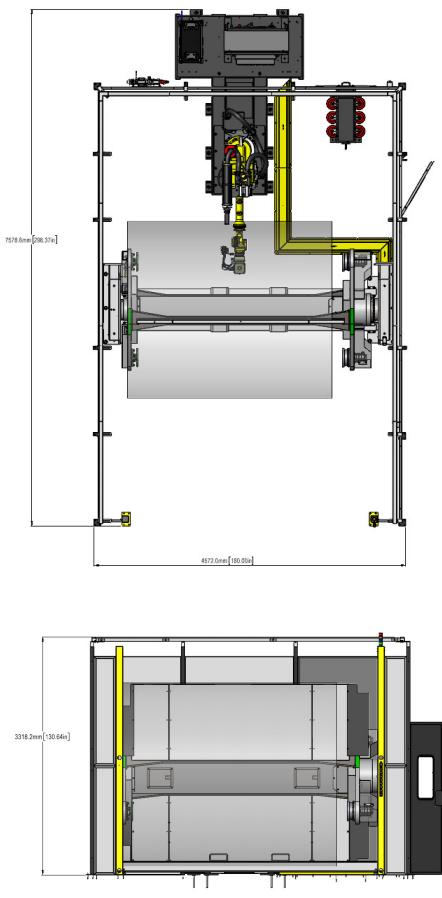

OmniClean XFT system

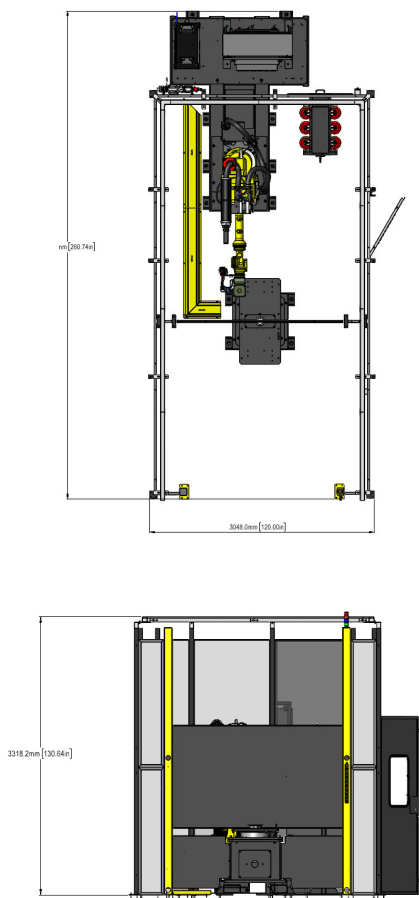

PRODUCT SPECIFICATIONS

Product Number	Model Name	Positioner Type	Cell Dimensions L x W in (mm)	Payload (kg)	Swing (mm)	Span (mm)
AD2479-3	FT	None	238 x 168 [6045 x 4267]	N/A	N/A	N/A
AD2479-4	XFT	Indexing Fixed Table	261 x 120 [6623 x 3048]	500	2250	N/A
AD2479-5	XFT-TR	Indexing Fixed Table - Tilt and Rotate	286 x 156 [7274 x 3962]	500	1500	N/A
AD2479-6	FHS	Headstock and Tailstock	238 x 168 [6045 x 4267]	1500	1250	3000
AD2479-7	FW	Ferris Wheel	298 x 180 [7579 x 4572]	1500	1500	3000
Custom	Based on Customer Specifications					

Important Note: Changes from recommended motor sizing, payload, duty cycles, cable routing, weld grounding (if applicable), other system specifications (i.e. servo parameters, controller stop parameter), and/or modifications may affect cycle times and overall performance. User assumes all responsibility for proper rigging, installation, and machine setting alignments of product(s). Manufacturer's warranty is void to the extent any failure caused by improper installation, modification, or operation by customer.

CUSTOMER ASSISTANCE POLICY

The business of Lincoln Electric is manufacturing and selling high quality welding equipment, automated welding systems, consumables, and cutting equipment. Our challenge is to meet the needs of our customers, who are experts in their fields, and to exceed their expectations. On occasion, purchasers may ask Lincoln Electric for information or technical information about their use of our products. Our employees respond to inquiries to the best of their ability based on information and specifications provided to them by the customers and the knowledge they may have concerning the application. Our employees, however, are not in a position to verify the information provided or to evaluate the engineering requirements for the particular weldment, or to provide engineering advice in relation to a specific situation or application. Accordingly, Lincoln Electric does not warrant or guarantee or assume any liability with respect to such information or communications. Moreover, the provision of such information or technical information does not create, expand, or alter any warranty on our products. Any express or implied warranty that might arise from the information or technical information, including any implied warranty of merchantability or any warranty of fitness for any customers' particular purpose or any other equivalent or similar warranty is specifically disclaimed.

Lincoln Electric is a responsive manufacturer, but the definition of specifications, and the selection and use of specific products sold by Lincoln Electric is solely within the control of, and remains the sole responsibility of the customer. Many variables beyond the control of Lincoln Electric affect the results obtained in applying these types of fabrication methods and service requirements.

THE LINCOLN ELECTRIC COMPANY
22801 Saint Clair Avenue • Cleveland, OH • 44117 • U.S.A.
Phone: +1 216.481.8100 • www.lincolnelectric.com