

ELECTRIC SLIDE

# SLIDEMATIC S50E / S100E

SAFETY INSTRUCTIONS FOR USE AND MAINTENANCE

DEVICE No W000274911 - W000315387

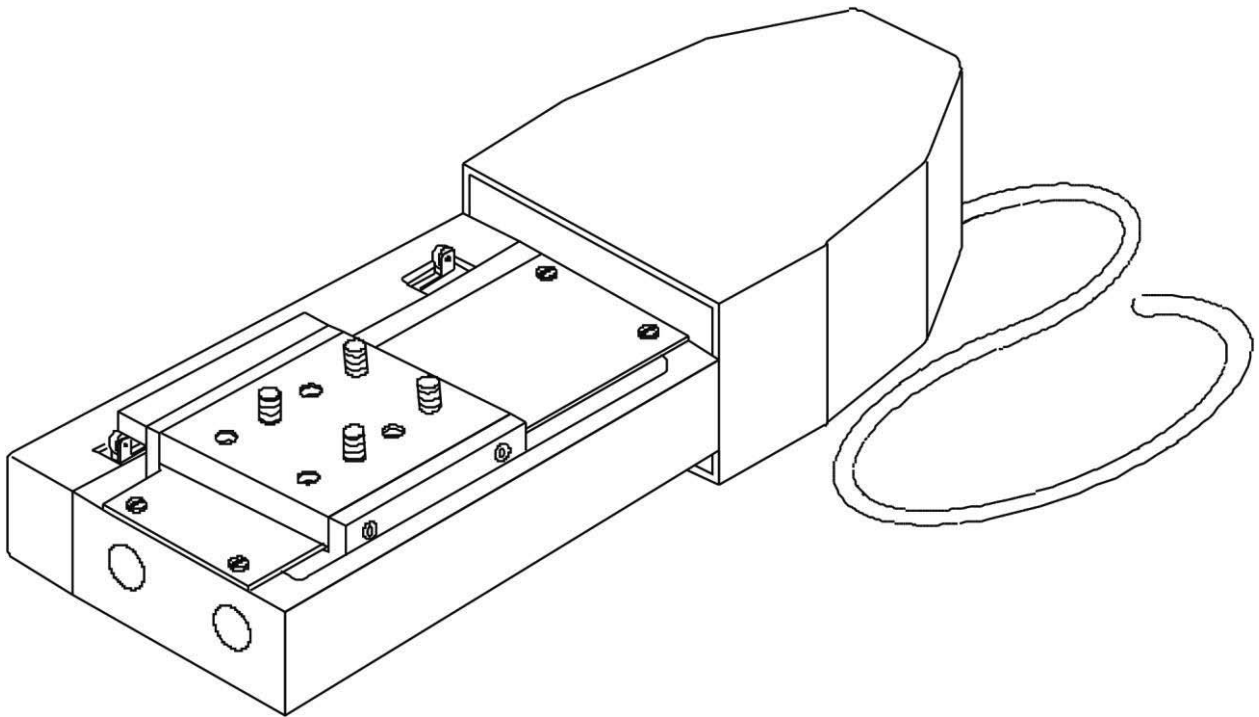

EDITION: EN  
REVISION: K  
DATE: 05-2018

Instructions for use

REF: **8695 6840**

*Original instructions*

**LINCOLN**<sup>®</sup>  
**ELECTRIC**

**Thank for the trust you have expressed by purchasing this equipment, which will give you full satisfaction if you follow its instructions for use and maintenance.**

**Its design, component specifications and workmanship comply with applicable European directives.**

**Please refer to the enclosed CE declaration to identify the directives applicable to it.**

**The manufacturer will not be held responsible where items not recommended by themselves are associated with this product.**

**For your safety, there follows a non-restrictive list of recommendations or requirements, many of which appear in the employment code.**

**Finally we would ask you kindly to inform your supplier of any error which you may find in this instruction manual.**

# CONTENTS

**A - IDENTIFICATION .....1**

**B - SAFETY INSTRUCTIONS.....2**  
AIRBORNE NOISE.....2  
PARTICULAR SAFETY INSTRUCTIONS .....2

**C - USER'S GUIDE .....3**  
1 - DESCRIPTION.....3  
2 - TECHNICAL CHARACTERISTICS.....4  
3 - OPTION W000315418 .....6

**D - SERVICING .....7**  
1 - ELECTRICAL DRAWING.....7  
2 - SERVICING.....7  
3 - SPARE PARTS .....8

**PERSONAL NOTES .....10**

## REVISIONS

### REVISION H 09/09

DESIGNATION	PAGE
Creation in several languages	

### REVISION I 07/11

DESIGNATION	PAGE
W000315424 → W000274911	

### REVISION J 02/13

DESIGNATION	PAGE
Spare parts	

### REVISION K 05/18

DESIGNATION	PAGE
To change logos	

# A - IDENTIFICATION

Please enter the number of your equipment in the following box.

Quote this information in all correspondence.

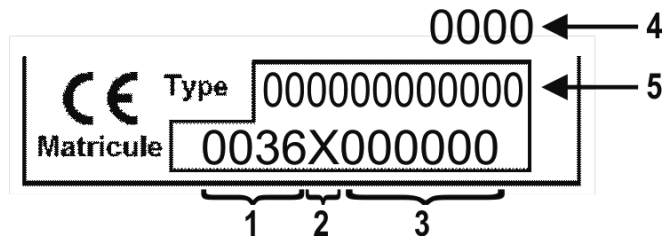

1	Manufacturing factory code	4	Year manufactured
2	Manufacturing year code	5	Product type
3	Product serial no.		

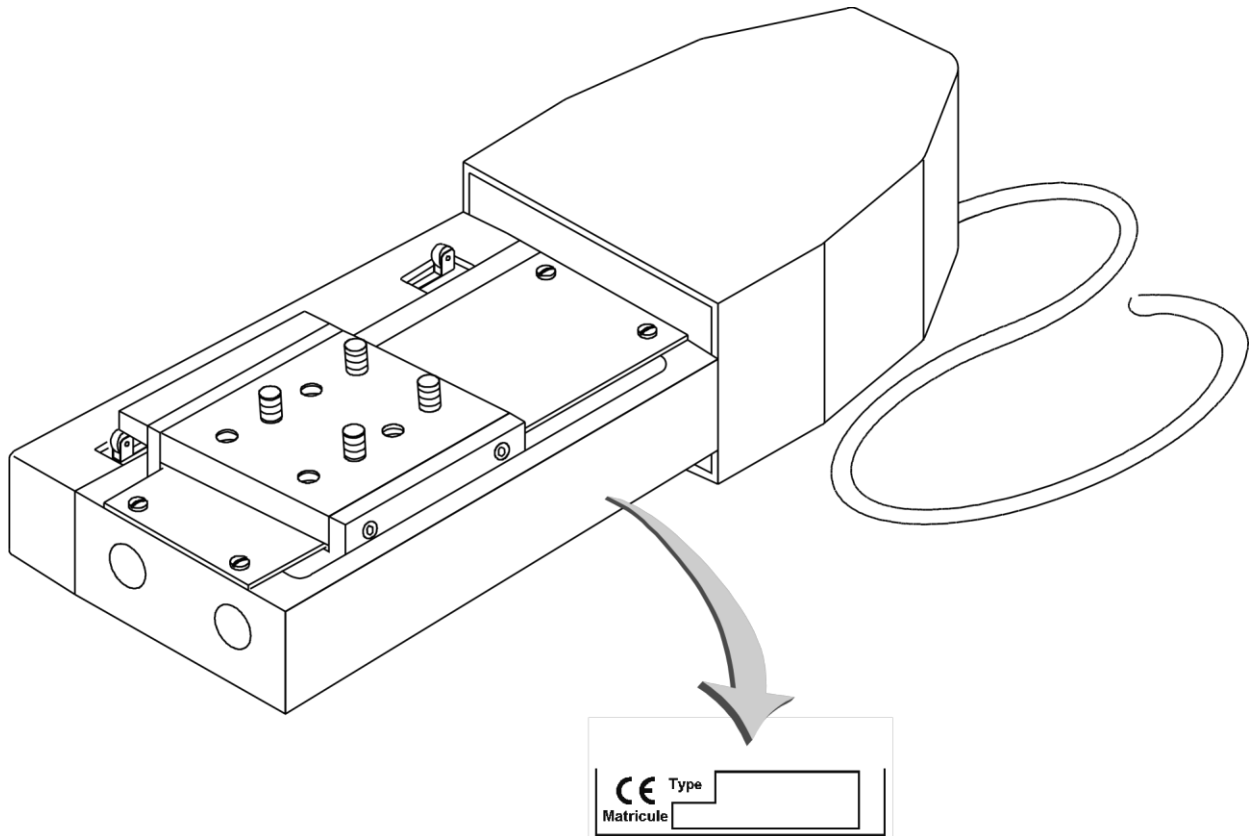

## B - SAFETY INSTRUCTIONS

For general safety instructions, please refer to the specific manual supplied with the equipment.



### AIRBORNE NOISE

Please refer to the specific manual supplied with the equipment.

### PARTICULAR SAFETY INSTRUCTIONS

- The torch slide-way assembly must be solidly attached to a rigid support using M6 screws with a pitch of 40.
- No obstacle must hamper the movement of the slide or of the parts attached to it.
- Respect the safe working loads on the slide.
- The loads must be solidly attached to the slide.

# C - USER'S GUIDE

## 1 - DESCRIPTION

It is attached to the machine by M6 screws with pitch 40.

The assembly is comprised of :

- A mechanical part made of aluminium with its geared slide motor.

Weight travel 50 : 3 Kg

Weight travel 100 : 3,150 Kg

### SLIDEMATIC S50 E

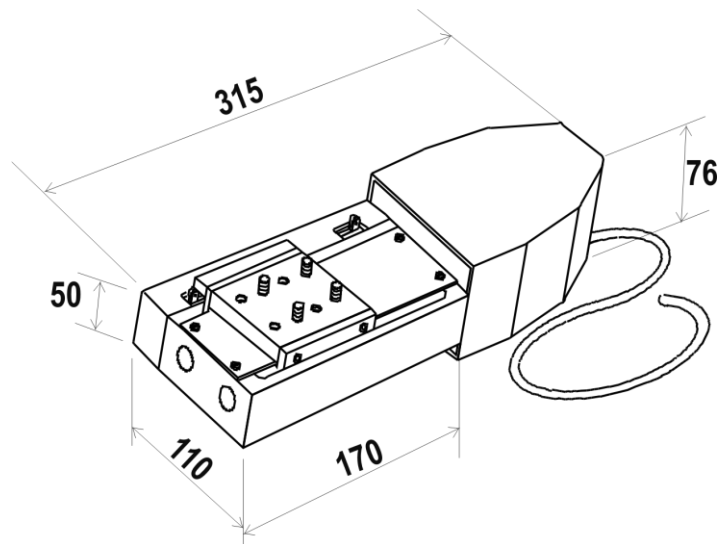

### SLIDEMATIC S100E

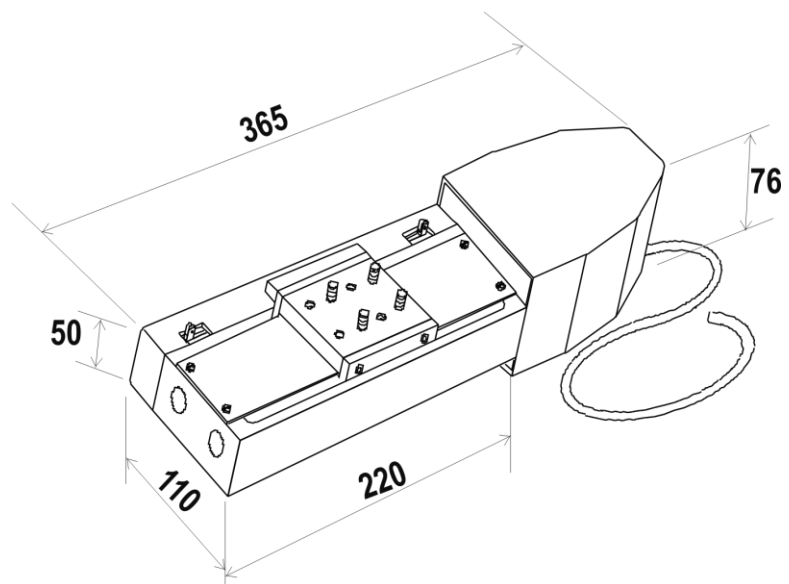

## 2 - TECHNICAL CHARACTERISTICS

Primary supply, single phase

Travel 50 24 VDC / 0.50 A

Travel 100 24 VDC / 0.50 A

### Slide displacement

-Travel = 50 and 100 mm

- Max speed = 5 cm/min

Electrical connections via cable length 2m

### Load

Maximum load

: 5 kg

Maximum torque = 0,175 mdaN

Load attached by :

- 4 holes M6 grid =  
40x40 mm

4 holes Ø 7 grid =  
40x40 mm

( 4 screws M6x16 included )

To attach the load, unscrew the 4 screws (item a) to remove the support plate

Load displacement must be horizontal.

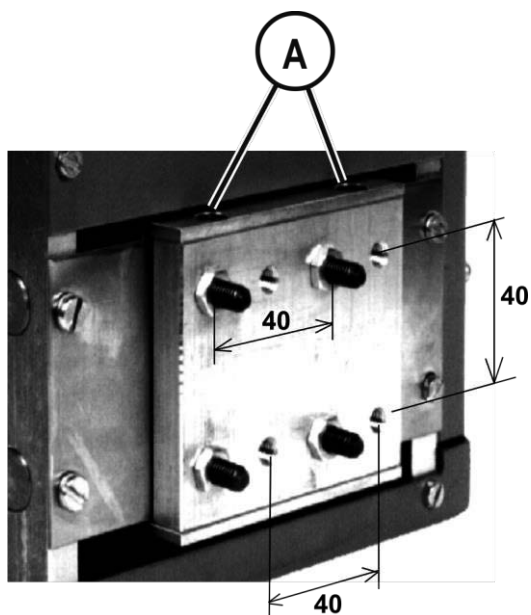
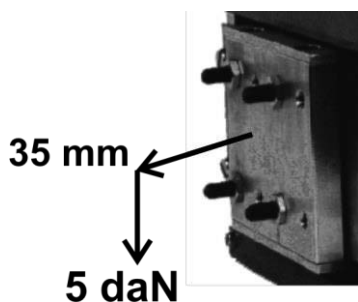





### 3 - OPTION W000315418

This remote control allows to make the remote movement (sense + or -) of the slide channel.

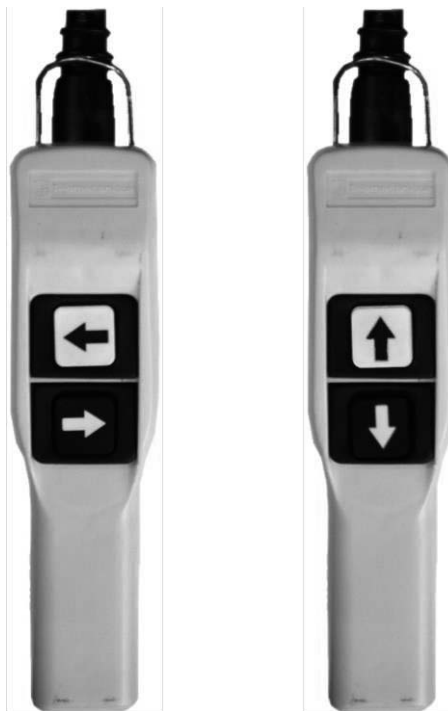

#### REMOTE CONTROL ELECTRICAL DRAWING

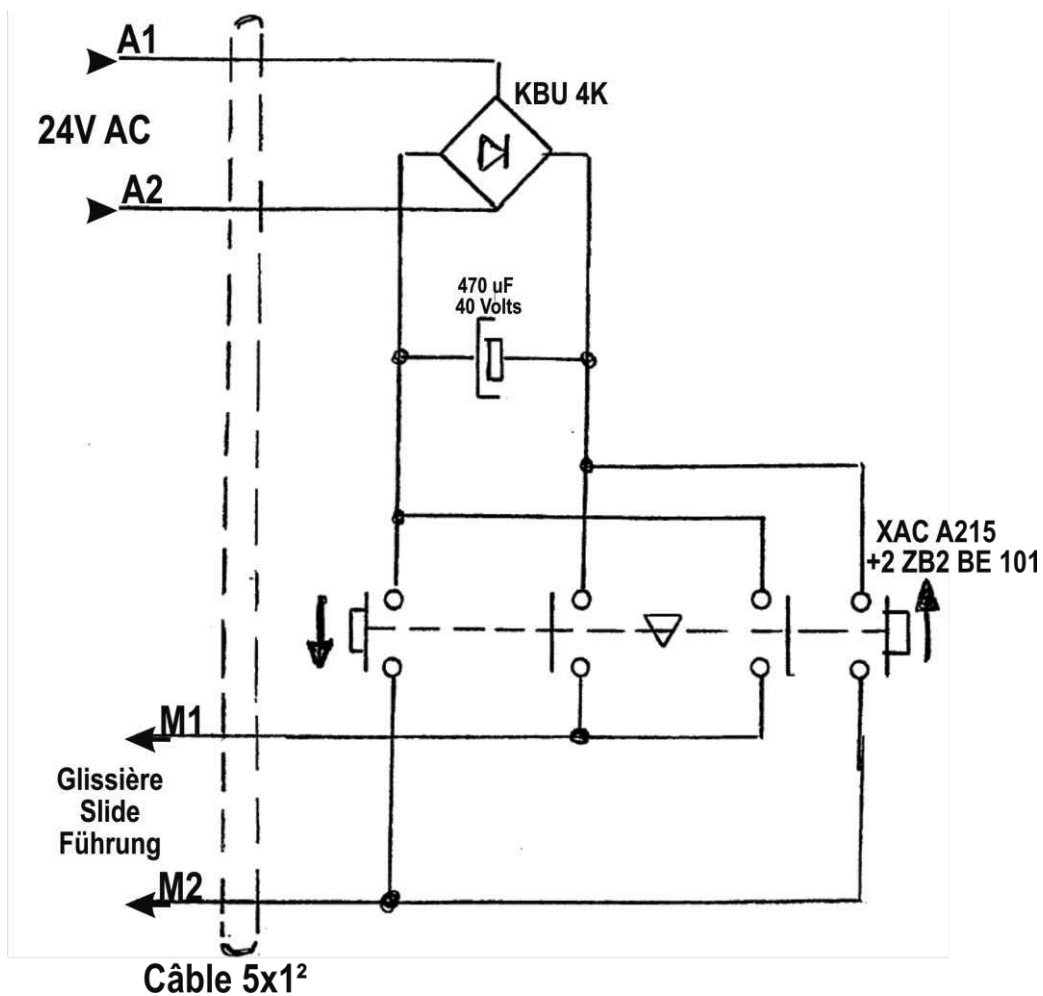

# D - SERVICING

## 1 - ELECTRICAL DRAWING

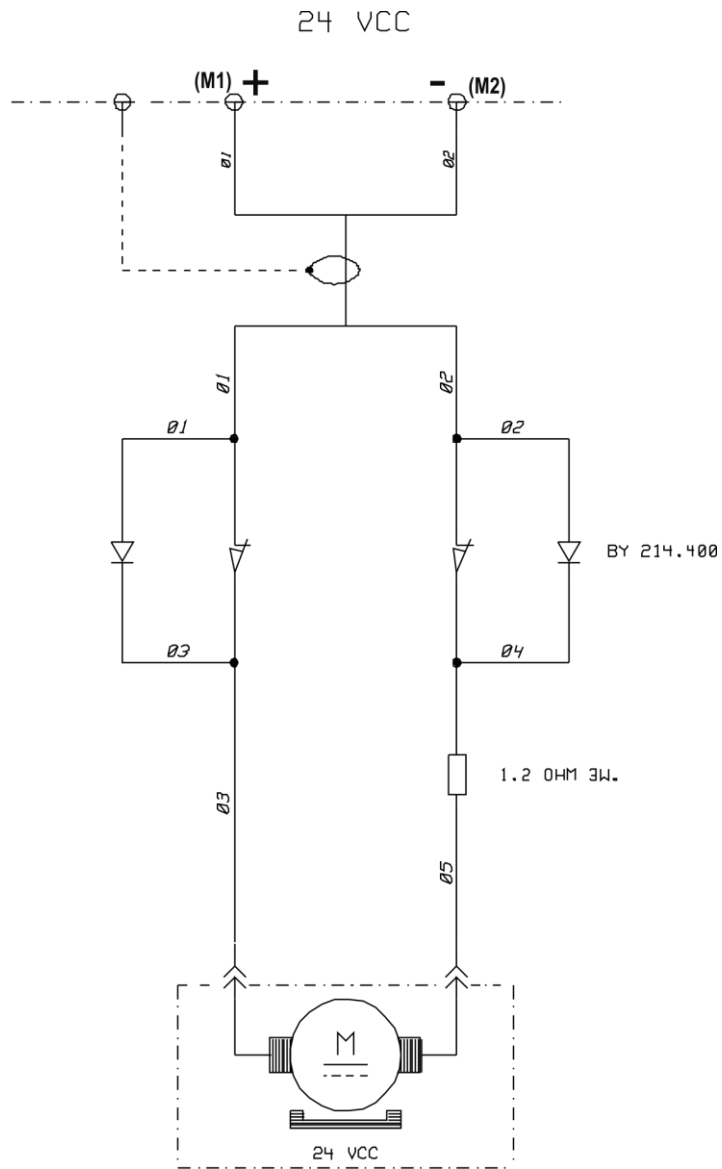

## 2 - SERVICING

- So that the machine continues to provide good service for as long as possible, a certain minimum of care and maintenance is necessary.

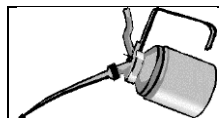

Lubricate the screw regularly and clean the guiding columns

### 3 - SPARE PARTS

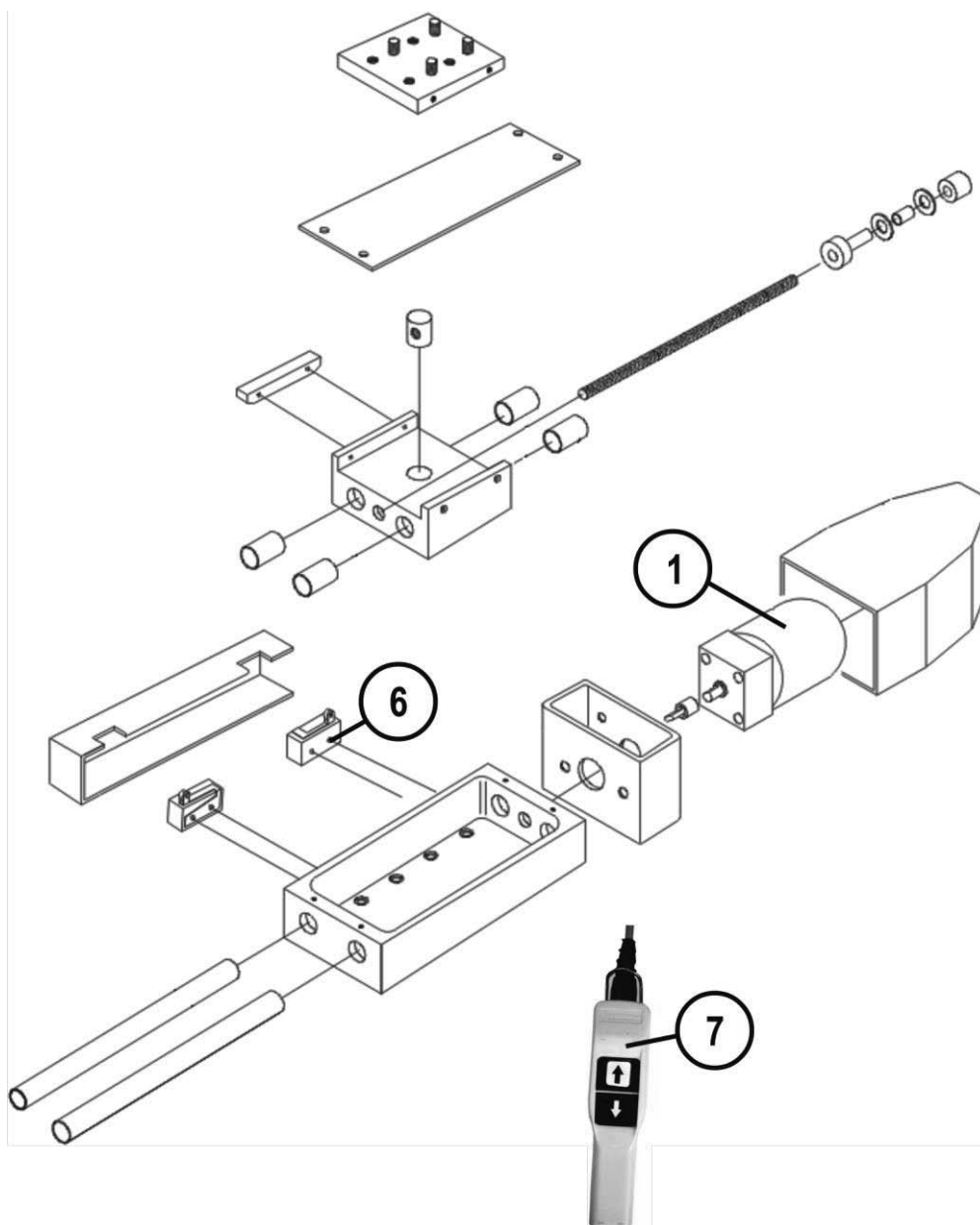

✓	normally in stock
✗	not in stock
	on request

Item	Ref.	Stock	Order	Designation
1	W000365992	✗		Geared motor
6	W000352100	✓		Microswitch (2 parts)
7	W000315418	✗		Remote control slide

➤ For parts order, give the quantity required and put the number of your machine in the box below.

	TYPE:
	Number:



