

# HELIX<sup>®</sup> M627

## ORBITAL WELD HEAD



### MECHANIZED GTAW - SIMPLIFIED

The HELIX M627 is the next innovation in our mechanized HELIX M Series orbital weld heads. With a low radial clearance of 2.87 in. (72.9 mm), the HELIX M627 weld head allows for precise, digitally controlled welding in a wide range of pipe and tube GTAW applications. With complete process control and operator-friendly design, the HELIX M627 delivers the market's leading solution for productivity and quality with mechanized GTAW.

#### Processes »

GTAW, Pulsed

#### Applications »

Fabrication, Power Generation, Pressure Vessels, Process Pipe

#### Output » Input »



#### Product Numbers »

K52283-1 – HELIX M627 Weld Head  
K52285-1 APEX<sup>®</sup> 30S M627 TIG Ready-Pak<sup>®</sup>

## KEY FEATURES

### Best-in-Class Performance

- Utilizing the latest in digital motor control technology, the HELIX M627 features consistent performance without the need for manual calibration at startup.
- APEX Auto Height, Auto Sector and AutoPilot Technology provides advanced travel speed and true oscillation width/speed control that delivers repeatable welds with minimal setup
- Automated control features minimizes operator training while improving operator availability.

### Versatile Design

- Low radial clearance – 2.87 in [68.5mm]
- Water-cooled motor housing and torch helps eliminate overheating
- Proven, versatile clamping mechanism allows the weld head to be disengaged and repositioned with one easy motion
- Interchangeable with HELIX M series family of weld heads.

## KEY CONTROLS

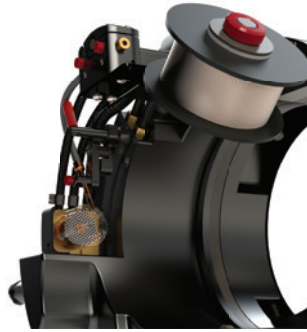

1. Integrated Wire Feeder
2. Water-Cooled Head



1. Simple Cable Management
2. Robust Design

## CONFIGURATION

### Application Flexibility

The HELIX M627 weld head provides flexibility for a wide range of tube and pipe applications, allowing quick adjustments to fit diameters ranging from 1.9 - 6.63 in [48.3 – 168.4 mm]

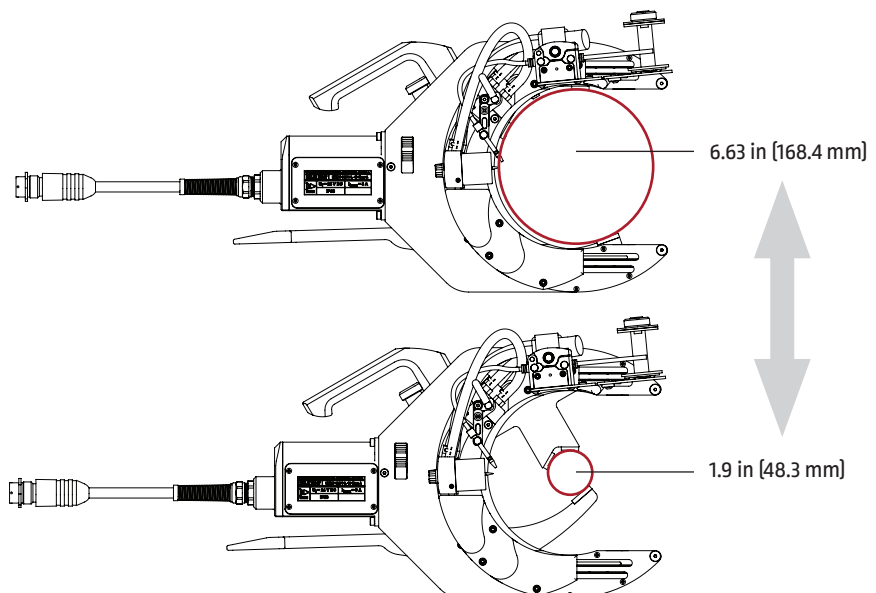

## WHATS INCLUDED



### HELIX M627 WELD HEAD – K52283-1

- HELIX M627 Weld Head
- Pelican Case for weld head storage
- HELIX M Clamp Expendables Kit
- Low Profile TIG Torch
- Low Profile Cable Retainer
- Clamp Shoe 6.625 in (168.3 mm)
- Clamp Shoe 5.563 in (141.3 mm)
- Clamp Shoe 4.5 in (114.3 mm)
- Clamp Shoe 4.0 in (101.6 mm)
- Clamp Shoe 3.5 in (88.9 mm)
- Clamp Shoe 2.875 in (73.0 mm)
- Clamp Shoe 2.375 in (60.3 mm)
- Clamp Shoe 1.9 in (48.3 mm)



### APEX 30S M627 TIG READY PAK – K52285-1

- Power Wave® S500 Advanced Process Welder
- APEX® 30S Mechanized Controller
- HELIX M627 Weld Head with Shoe Kit  
1.9 - 6.63 IN (48.3 - 168.3 MM)
- APEX® 3 Series TIG Pendant
- Cool Arc® 55 S Water Cooler
- Inverter and Wire Feeder Cart



## RECOMMENDED ACCESSORIES



### PART & ACCESSORIES

Part Number	Description
K52246-25	Water-Cooled Cable/Hose Extension 25 ft. (7.6 m)
KP52110-1	Low Profile Back Cap
KP4745-S	Back Cap Short
KP4745-M	Back Cap Medium
KP4745-L	Back Cap Long
KP2029-5B1	1/8 Collet
KP2029-4B1	3/32 Collet
KP2029-3B1	1/16 Collet
KP52145-1	Collet Body
KP52063-1	1/8 Tungsten Adapter
KP52063-2	3/32 Tungsten Adapter

### CLAMP SHOES

Part Number	Description
K52093-663	Clamp Shoe 6.625 in (168.3 mm)
K52093-556	Clamp Shoe 5.563 in (141.3 mm)
K52093-450	Clamp Shoe 4.5 in (114.3 mm)
K52093-400	Clamp Shoe 4.0 in (101.6 mm)
K52093-350	Clamp Shoe 3.5 in (88.9 mm)
K52093-288	Clamp Shoe 2.875 in (73.0 mm)
K52093-238	Clamp Shoe 2.375 in (60.3 mm)
K52093-190	Clamp Shoe 1.9 in (48.3 mm)
KP2093 - XXX	Custom Sizes Available

### DRIVE ROLL KITS

Part Number	Description
KP52094-030	Drive Roll Kit, Solid Wire .030 (0.8)
KP52094-035	Drive Roll Kit, Solid Wire .035 (0.9)
KP52094-040	Drive Roll Kit, Solid Wire .040 (1.0)
KP52094-045	Drive Roll Kit, Solid Wire .045 (1.2)
KP52100-035	Wire Guide Tip .030-.035 in. (0.8-0.9 mm)
KP52100-045	Wire Guide Tip .040-.045 in. (1.0-1.2 mm)
K52289-035	Onboard Feeder Inlet/Outlet Guide Set .030-.035 in. (0.8-0.9 mm)
K52289-045	Onboard Feeder Inlet/Outlet Guide Set .040-.045 in. (1.0-1.1 mm)



## PRODUCT SPECIFICATIONS

Product Name	Product Number	Input Power	Rated Current	Wire Feed Speed ipm (m/min)	Wire Diameter in (mm)	Travel Speed
Helix M627	K52283-1	24 VDC	500 A	1-300 (0.03 - 7.62)	0.030-0.045 (0.8 - 1.2)	.04-4.76 rpm

Radial Clearance* in (mm)	Axial Clearance in (mm)	Oscillation Stroke in (mm)	Height Stroke in (mm)	Dimensions H x W x D in (mm)	Net Weight lb (kg)
2.87 (72.9)	8.32 (211.3)	1 (25.4)	3.79 (96.2)	8.32 x 11.4 x 26.0 (211.3 x 289.5 x 660.4)	32(14.5)

\*On a 6.625 in diameter pipe

For best welding results with Lincoln Electric® equipment, always use Lincoln Electric consumables. Visit [www.lincolnelectric.com](http://www.lincolnelectric.com) for more details.

### CUSTOMER ASSISTANCE POLICY

The business of The Lincoln Electric Company® is manufacturing and selling high quality welding equipment, consumables, and cutting equipment. Our challenge is to meet the needs of our customers and to exceed their expectations. On occasion, purchasers may ask Lincoln Electric for information or advice about their use of our products. Our employees respond to inquiries to the best of their ability based on information provided to them by the customers and the knowledge they may have concerning the application. Our employees, however, are not in a position to verify the information provided or to evaluate the engineering requirements for the particular weldment. Accordingly, Lincoln Electric does not warrant or guarantee or assume any liability with respect to such information or advice. Moreover, the provision of such information or advice does not create, expand, or alter any warranty on our products. Any express or implied warranty that might arise from the information or advice, including any implied warranty of merchantability or any warranty of fitness for any customers' particular purpose is specifically disclaimed.

Lincoln Electric is a responsive manufacturer, but the selection and use of specific products sold by Lincoln Electric is solely within the control of, and remains the sole responsibility of the customer. Many variables beyond the control of Lincoln Electric affect the results obtained in applying these types of fabrication methods and service requirements.

Subject to Change – This information is accurate to the best of our knowledge at the time of printing. Please refer to [www.lincolnelectric.com](http://www.lincolnelectric.com) for any updated information.

**The Lincoln Electric Company**  
22801 St. Clair Avenue · Cleveland, OH · 44117-1199 · U.S.A.  
[www.lincolnelectric.com](http://www.lincolnelectric.com)