

PARTS LIST

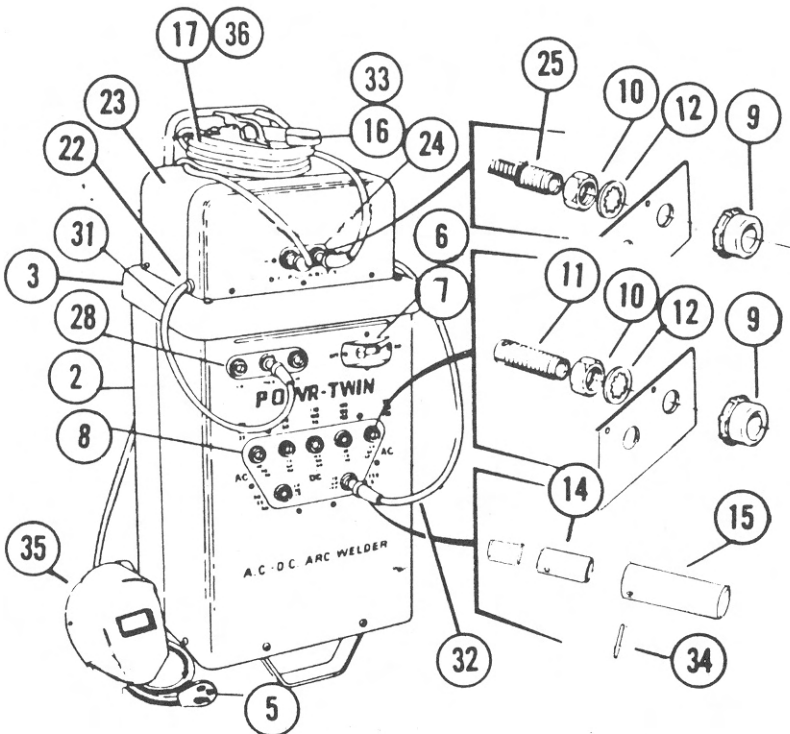
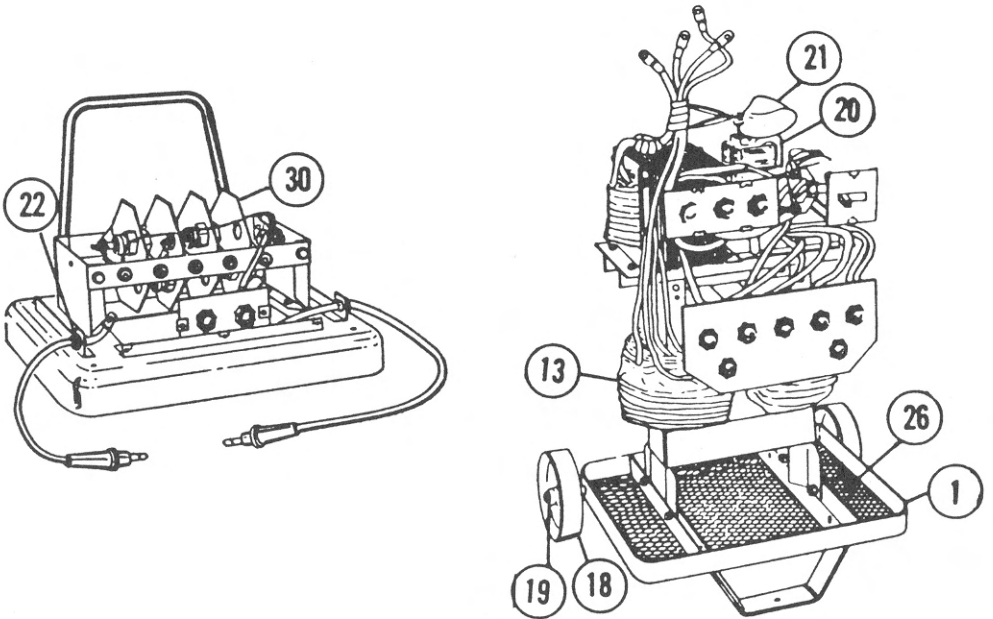

PARTS LIST

ORDERING INSTRUCTIONS

To avoid delays and assure correct replacement parts, always include the following information with the parts order:

1. Model and serial number.
2. Part number and description.
3. Quantity of parts desired.

NOTE: Do not use the Item numbers when ordering replacement parts.

Order Parts From: Marquette Manufacturing Co., South Main & Werner Streets, Bangor, Pennsylvania 18013, Attention: Service Parts Department.

ITEM	PART NO.	DESCRIPTION
1	617-69744	Welded Base Assembly
2	619-69739	Cabinet Assembly
3	617-69746	Cover Assembly
4	619-55511	Specification Plate
5	633-58332	Power Cord Set
6	627-47671	Power Switch
7	610-47914	Switch Guard
8	619-69738	Electrode Terminal Panel
9	699-40529	Terminal Nut
10	699-50763	Terminal Post Nut
11	611-71201	Terminal Post
12	699-50976	Terminal Post Lockwasher
13	618-51741	Transformer Assembly
14	611-71219	Cable Plug
15	649-71222	Cable Plug Insulator
16	634-67112	Electrode Cable Assembly
17	634-67116	Work Cable Assembly
18	629-40074	Wheel (Cast Iron)
19	699-47849	Wheel Retaining Ring
20	617-46861	Fan Motor
21	626-59883	Fan Blade
22	665-47987	Strain Relief Bushing
23	619-69737	Cabinet Assembly
24	613-51462	Terminal Panel
25	611-47774	Terminal Post
26	668-50316	Base Screen
28	613-40222	Work Terminal Panel
30	617-52130	Rectifier Assembly
31	617-50297	Short Jumper Cable Assy.
32	617-51836	Long Jumper Cable Assy.
33	685-40705	Electrode Holder
34	613-71223	Pin
35	50-100	Helmet
36	651-58847	Work Clamp

All parts FOB shipping. Manufacturer reserves the right to make changes in design, construction or materials as necessary.