

83140, M02170, WFW170, 117-087

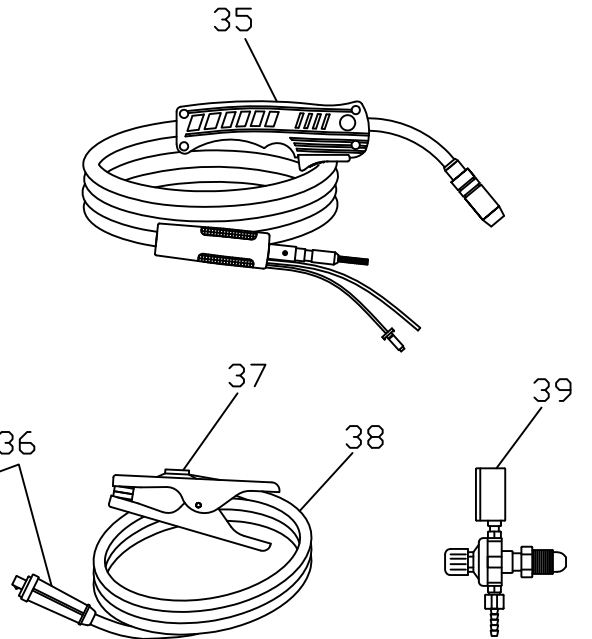
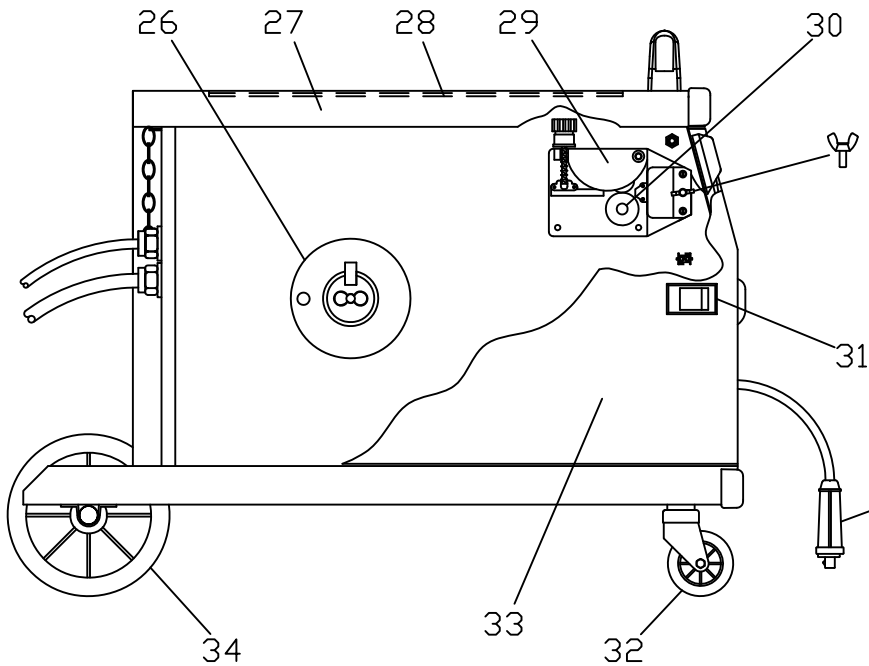
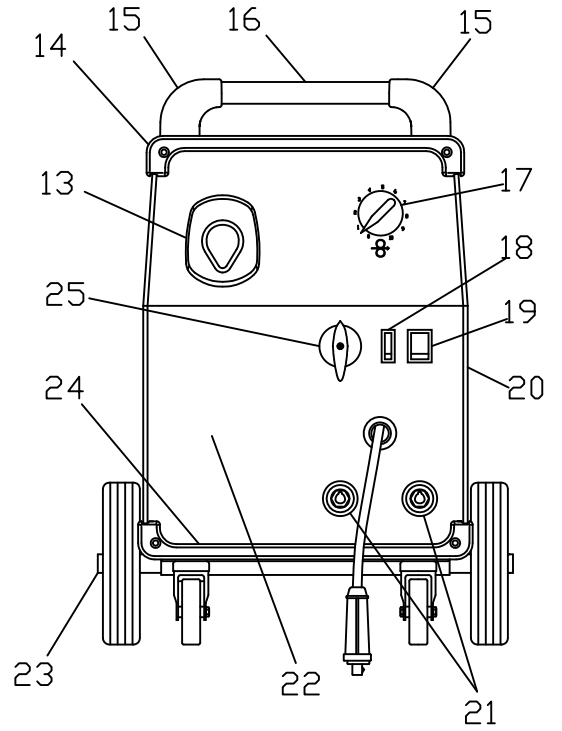
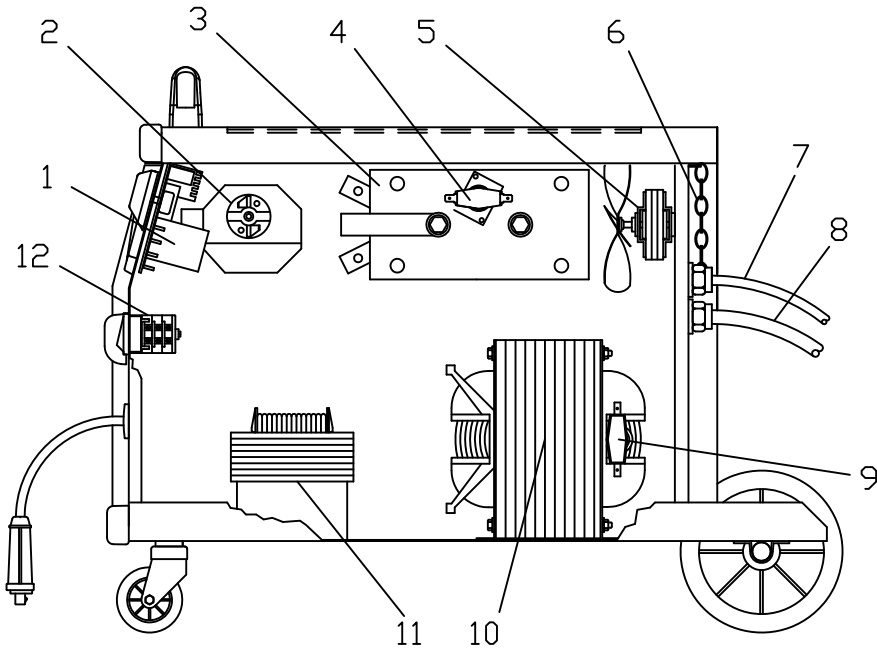

117-087, 83140, M02170, WFW170

Item	Lincoln Stock #	Customer #	Description
1	880-575-666	22710037	Circuit Board
2	216-107-666	22810002	Wire Feed Motor
3	880-574-666	22400005	Rectifier
4	246-507-666	4600113	Thermostat
5	216-106-666	22800039	Fan Motor & Blade
6	412-747-666	10990010	Chain
7	059-245-666	30900027	Gas Hose
8	248-378-666	20220115	Power Cord
9	246-512-666	22210016	Thermostat
10	880-577-888	44120045	Main Transformer
11	880-576-888	44135017	Reactor Coil
12	246-511-666	22205116	Rate Switch
13	312-508-666	21690268	Mig Gun Connector
14	312-510-666	21690362	Upper Frame
15	312-506-666	21600031	Handle Support (2)
16	412-748-666	33725085	Handle
17	246-508-666	21690107	Wire Speed Knob
18	246-510-666	22200006	Current Switch
19	246-509-666	22200002	On/Off Switch
20	411-105-026	33705385	Right side panel
21	239-294-666	22100002	Input jack female (2), 25mm
22	411-111-116	05000006	Front panel - 83140
23	413-113-666	55200032	Axle
	M21460-13	21050002	Wheel retaining ring
24	312-511-666	21690363	Lower Frame
25	246-505-666	21690371	Switch Knob - Red
26	880-573-666	04600001	Wire Spool Assembly
27	411-104-026	33705384	Cover
28	512-263-666	30905029	Rubber Mat
29	312-509-666	44400023	Wire Tensioner

Item	Lincoln Stock #	Customer #	Description
30	310-210-666	33805001	Drive Roller
31	312-507-666	21690226	Slide Clip
32	413-111-666	21625001	Caster (2)
33	411-106-026	33705386	Left Side Panel
34	413-112-666	21625033	Wheel (2)
35	880-584-000	M15221	Mig gun Assembly
36	434-003-666	M15542	Male input Jack (2), 25mm
37	239-292-666	41007	Ground Clamp
38	238-702-666	43210138	Ground Cable
39	334-303-001	334-286-666	Regulator

Not Shown

40	334-468-666	M15223	Steel Liner
41	411-122-666	M15225	Teflon Liner
42	KP21T-50, KH725	43480, M15578, 334-203-000	Nozzle for Steel Welding
	KP21T-62	43300, 334-210-300	Nozzle for Aluminium Welding
	KP21-62-FAS	43290, KP1956-1, M15577 334-211-300	Spot Welding Nozzle
	KP1939-1, KH726		Flux Core Nozzle
43	KP11-25, KH710	43090, M15522 334-159-300, KP2039-1B1	Contact Tips .025"
	KP11-30, KH711	43100, M15523, 334-160-300, KP2039-2B1	Contact Tips .030"
	KP11-35, KH712	43110, M15524, 334-161-300, KP2039-3B1	Contact Tips .035"
	KP11-45, KH713	43390, M57242, 334-202-300, KP2039-4B1	Contact Tips .045"
44	334-439-000	23005146	Gas Diffuser
45	334-462-000	23005145	Conductor Tube w/cover
46	334-461-000	23005206	Trigger & Torch Handle
47	334-466-000	23005009	Gas Valve
48	M21460-14	21690209	Gun hold down screw
49	M21460-15	21690209	Gun hold down cover
50	M21460-16	21010036	Wing Thumb Screw
51	414-020-666	B7018380	Gas hose strain relief

Model	Primary Input	Input Plug	Duty Cycle at Rated Output
117-087	230V	50A	25%

Rated Output	Voltage Settings	Agency Listing	Max Output
140 amps	6	CSA	160 amps

**117-087, 83140,
M02170, WFW170**

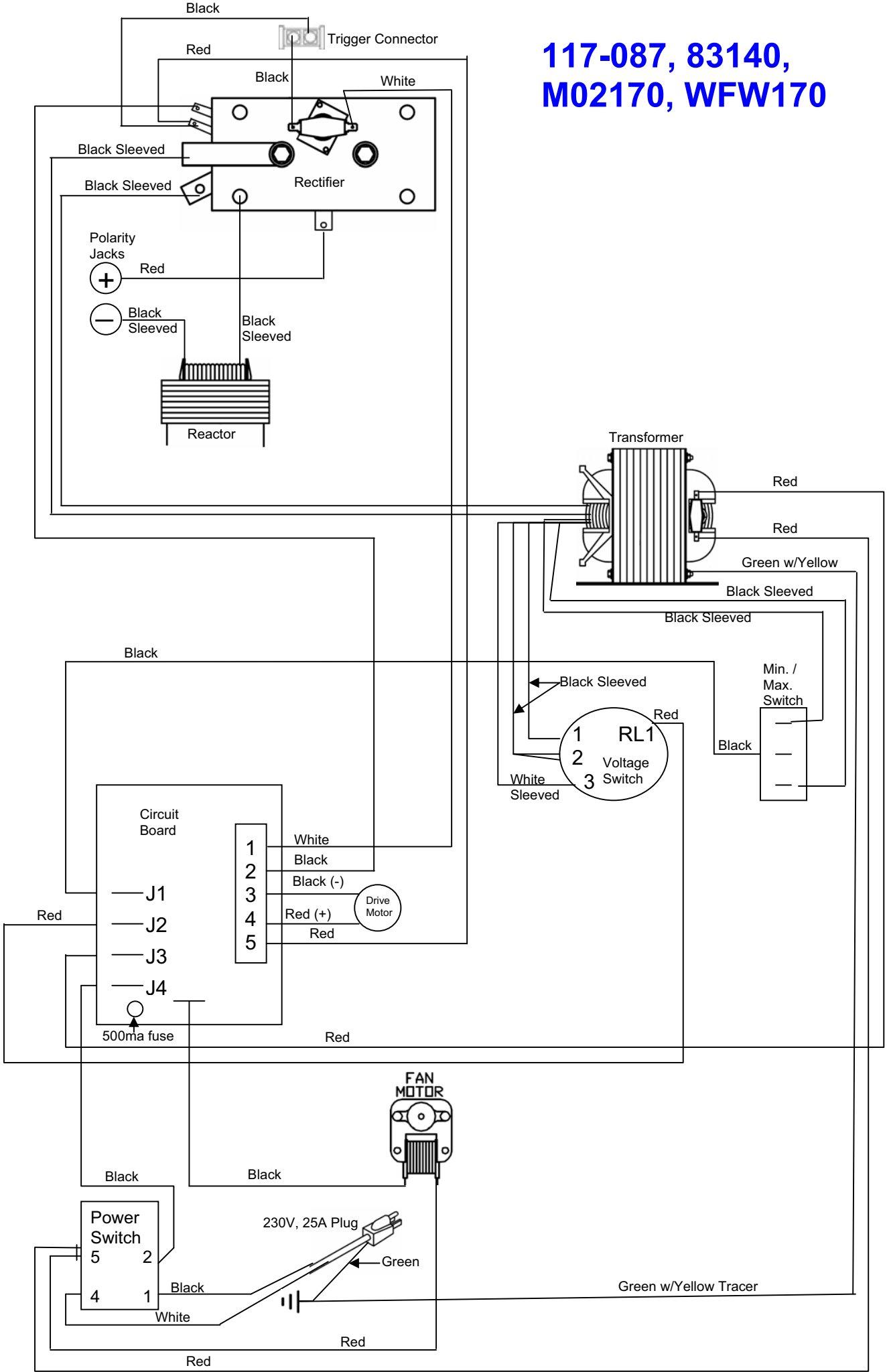

Transformer Output Vac

	Min	Max
1	22.1	25
2	26.3	30.6
3	32.4	39.3

Welder Open Circuit DC Volts

	Min	Max
1	19	21.5
2	22.5	26.5
3	28	34

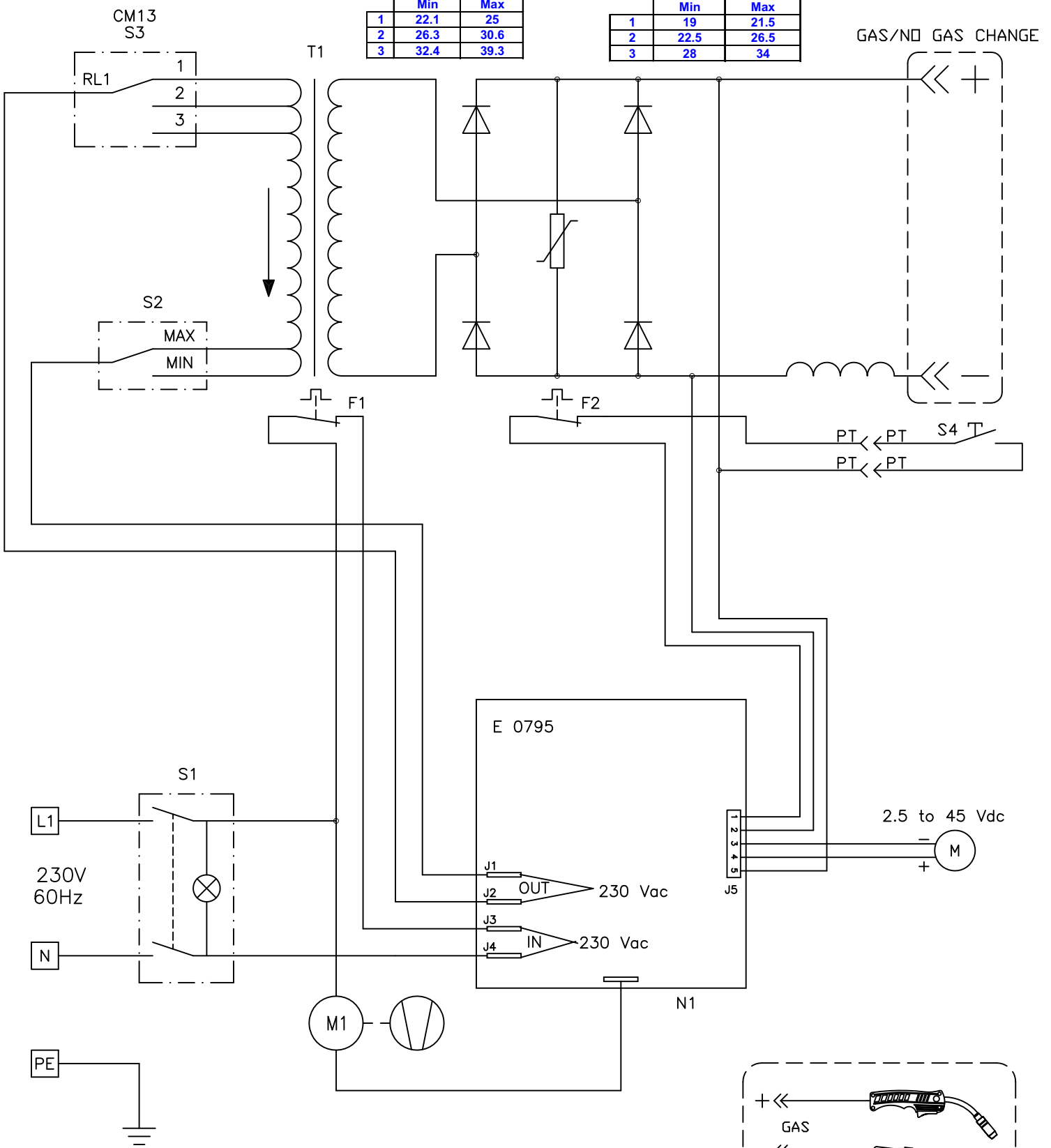

CM13

		RL1		
		1	2	3
POSITION	1	X		
	2		X	
	3			X

