

# 084 SPRAY WAND

Ergonomic Spray Wand with Linear Flow Control



Light and easy to use, the 084 is a hand spray wand designed for all industries. Featuring a narrow body with low grip force to activate, the 084 helps reduce ergonomic strain heavy wands can cause.

Lincoln Electric's 084 Wand utilizes all billet machined parts to produce a high quality wand with a two stage trigger operation. Choose between an air blast only first stage or completely compress to activate the atomized spray second stage.

#### Ideal For »

Die Casting, Forging, Stamping, or Rubber Molding where die cooling or fine coating control is needed.

#### What's Included »

- Front End
- Spray Wand
- Two Stage Trigger
- Liquid Metering Screw
- Supply Hoses Optional

## FEATURES

- » Modular front end in various lengths
- » Low grip force to activate
- » Narrow body
- » All billet machined parts
- » 2 stage operation: air blast only or air/lube atomized spray

## KEY CONTROLS

1. Modular front end in various lengths
2. M8 set screw
3. Max flow orifice assembly
4. Lubricant or liquid metering assembly
5. Aluminum trigger lever with low grip force to activate
6. Complete re-build kit of springs and o-rings
7. 084 Extension handle

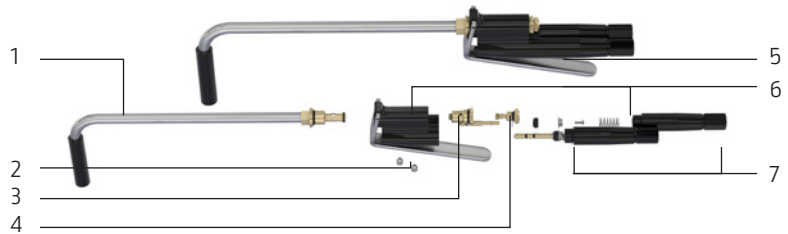

## MACHINE SPECIFICATIONS

Product Name	Product Number	System Dimensions L x W x H – in	Air Flowrate	Lube Flowrate	Filtration	Connections	
084 Wand	AD-2488-1	7 x 1.8 x 1.7	13 SCFM	0-1 GPM (Adjustable)	80 Mesh (200 Micron)	Air 1/4 FNPT (#6 hose)	Liquid 1/4 FNPT (#4 Hose)

## 084 PART NUMBER SCHEME (A4009248-A-B-C)

A	Hoses	
0	No 8 ft hoses	–
1	With 8 ft hoses	A4007057 (Lube) A4006798 (Air)
B	Front End Length	
00	No Front End Extension	–
12	12 in Front End Extension	A4009163-12
18	18 in Front End Extension	A4009163-18
24	24 in Front End Extension	A4009163-24
36	36 in Front End Extension	A4009163-36
48	48 in Front End Extension	A4009163-48
C	Metering Style	
0	Variable [0 -1.0 GPM]	A4005681
1	Low Flow Fixed [0.1 GPM]	A4007423-04
2	Medium Flow Fixed [0.5 GPM]	A4007423-24
3	High Flow Fixed [1.0 GPM]	A4007423-50

## CUSTOMER ASSISTANCE POLICY

The business of The Lincoln Electric Company is manufacturing and selling high quality welding equipment, consumables, and cutting equipment. Our challenge is to meet the needs of our customers and to exceed their expectations. On occasion, purchasers may ask Lincoln Electric for information or advice about their use of our products. Our employees respond to inquiries to the best of their ability based on information provided to them by the customers and the knowledge they may have concerning the application. Our employees, however, are not in a position to verify the information provided or to evaluate the engineering requirements for the particular weldment. Accordingly, Lincoln Electric does not warrant or guarantee or assume any liability with respect to such information or advice. Moreover, the provision of such information or advice does not create, expand, or alter any warranty on our products. Any express or implied warranty that might arise from the information or advice, including any implied warranty of merchantability or any warranty of fitness for any customers' particular purpose is specifically disclaimed.

Lincoln Electric is a responsive manufacturer, but the selection and use of specific products sold by Lincoln Electric is solely within the control of, and remains the sole responsibility of the customer. Many variables beyond the control of Lincoln Electric affect the results obtained in applying these types of fabrication methods and service requirements.

Subject to Change – This information is accurate to the best of our knowledge at the time of printing. Please refer to [www.lincolnelectric.com](http://www.lincolnelectric.com) for any updated information.