

# TOMAHAWK® 30 AIR

## PLASMA CUTTER



Shown:  
K5457-1

### PLASMA CUTTING WITH BUILT-IN AIR

The Tomahawk® 30 Air plasma cutting system arrives ready to go for fast and precise cutting. With its built-in air compressor, this machine is perfect for anyone who needs a reliable, portable cutting tool. With the Tomahawk 30 Air, forget the grinder – simply pick up the torch and cut in seconds. Plus, it also has external air capabilities, so you can use it with an external compressor if you need to. So whether you're working in your garage or out in the field, the Tomahawk 30 Air is the perfect tool for the job.

#### Processes »

Plasma Cutting & Grid

#### Applications »

On site maintenance, Small construction sites, Air ducting installation (HVAC), Demolition work, Rental

#### Output »



#### Input »



#### Product Numbers »

K5457-1 TOMAHAWK® 30 AIR

#### Cut Performance - Mild Steel»

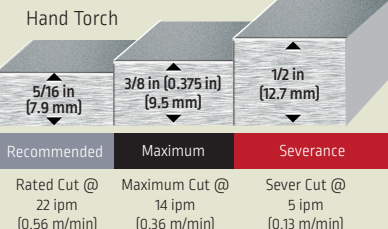

## VALUE-ADDED FEATURES

- **Ultimate Portability** – Internal air compressor enables operation in environments where external compressed air is not available.
- **Continuous Output Control** – Focus the arc for various material thickness.
- **Touch Start system** – Reliable plasma arc initiation without high frequency.
- **Rapid Arc Restrike** – Fast cutting through gaps, even expanded metal.
- **Front Panel Purge Control** – Makes it easy to set the air flow rate without initiating the plasma arc.
- **Cool Operation, Long Consumable Life**  
Enhanced swirling airflow keeps the electrode and tip cool and increases the life of consumables.
- **Added Safety** – Our Parts-in-Place system detects correct installation of consumables and torch.
- **Engine Drive Compatible** – Select a Lincoln Electric recommended engine driven welder / generator to power your Tomahawk in remote locations.

## KEY CONTROLS

- |                                   |  |
|-----------------------------------|--|
| 1. Handle                         | 5. On/Off Switch                                 |
| 2. Internal Compressor Air Filter | 6. Input Cord                                    |
| 3. Plasma Torch Connection        | 7. Air Inlet ( for external Compressed Air only) |
| 4. Workpiece Lead Connection      | 8. Cooling Fan                                   |



## USER INTERFACE

1. Output Current Knob
2. Power On/Off LED Indicator (Green)
3. Thermal Status LED Indicator (Yellow)
4. Parts in Place Status (Red)
5. Output Status LED Indicator (Red)
6. Air Purge
7. Internal / External Compressor Switch
8. Air Pressure Gauge
9. Air Pressure Adjustment

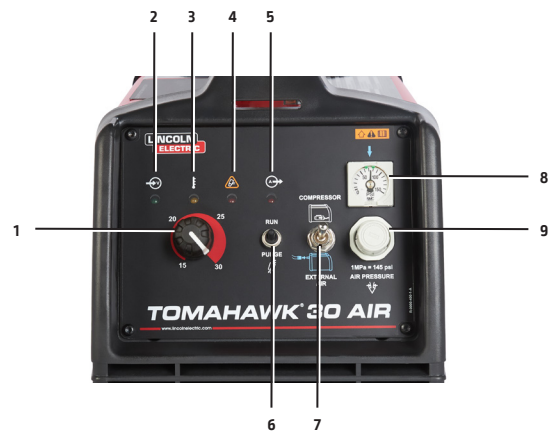

## TORCH DESIGN FOR OPTIMAL STARTING AND PERFORMANCE

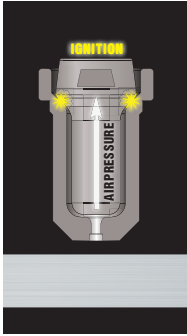

### Starting

- Air pressure pushes the electrode back
- Ignition takes place on the 'shoulder'
- No damage to the tip



- Extended consumable lifetime
- Consistent starting without High Frequency

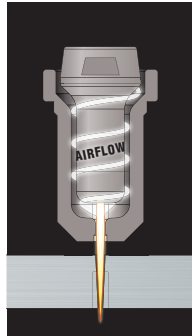

### Performance

- Enhanced swirling airflow
- Improved radius and electrode/nozzle design



- More concentrated arc
- Faster cutting speeds
- Greater thickness cutting capacity

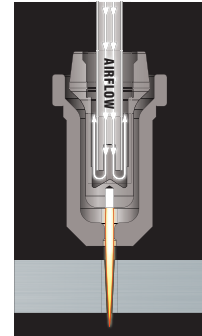

### Consumable Life

- Internal airflow keeps the electrode and tip cool



- Increases life of consumable components
- Lower operating costs

## CUTTING PERFORMANCE MILD STEEL

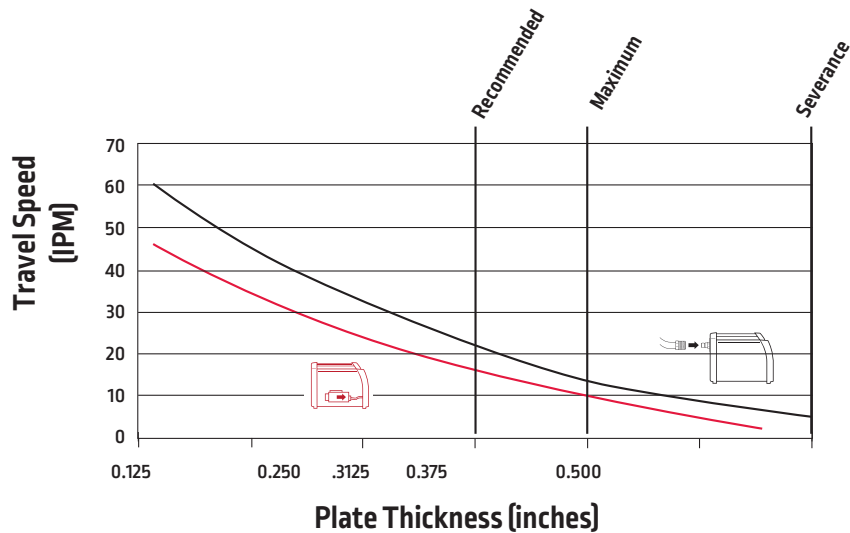

Aluminum cutting speeds are typically 10-20% faster than mild steel.  
Stainless steel cutting speeds are typically 10-20% slower than mild steel.

## LC30 CUTTING CONFIGURATION

### STAND-OFF

In the standard cutting configuration, the nozzle is designed for a user-maintained gap between the nozzle and the workpiece, unless the spacer is attached. Standard cutting allows maximum arc visibility and is recommended for higher current levels and thicker plate. Standard cutting parts are included with the torch

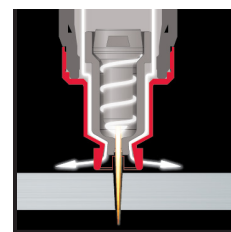

## LC30 REPLACEMENT TORCH CONSUMABLES

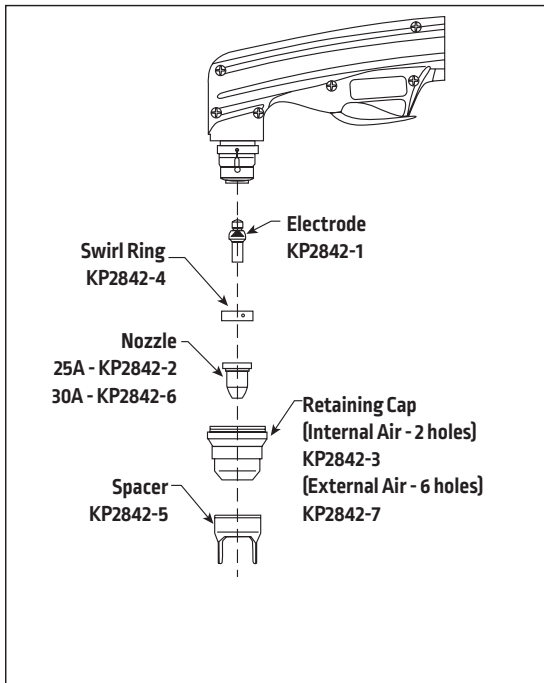

### TOMAHAWK® 30 AIR TORCH CONSUMABLES

Product Number	Description
KP2842-1	Electrode
KP2842-2	Nozzle 25A
KP2842-3	Retaining Cap (Internal Air - 2 holes)
KP2842-4	Swirl Ring
KP2842-5	Spacer
KP2842-6	Nozzle 30A
KP2842-7	Retaining Cap (External Air - 6 holes)

#### Consumable Wear

- It is normal for the electrode and nozzle to wear during operation.
- Electrodes should typically be replaced when erosion reaches 0.025 in. (0.65 mm).
- A green and erratic arc will indicate end of electrode life. The electrode should be immediately replaced.
- It is recommended that the KP2842-1 Electrode and KP2842-6 Nozzle (30A) be replaced as a complete set.



## WHAT'S INCLUDED

	Base Unit (K5457-1)
Internal air compressor (external air connection also standard)	•
LC30 PlasmaTorch with 10 ft. (3 m) cable	•
Air regulator and pressure gauge	•
Internal water separator	•
Work clamp and cable	•
Spare consumables	•
Shoulder strap	•
Input power cord	•



## RECOMMENDED ACCESSORIES



**Plasma Circle Cutting Guide Kit**  
For cutting circles from 3-33 in. (77-838 mm) in diameter. Works with all Lincoln LC series plasma torches.  
Order K2886-1



**Small Canvas Cover**  
Protect your Tomahawk when not in use. Made from red canvas that is flame retardant, mildew resistant and water repellent.  
Order K2377-1



**Canvas Accessory Bag**  
Canvas bag available to store your welding accessories with convenient carrying handle and snaps to attach to your equipment.  
Order K3071-1



**Lincoln Electric LC30 Replacement Torch**  
Includes 10 ft. (3 m) torch cable and one set of all required torch expendable parts.  
Order K5537-1



**OMNISHield™ Flip-Up Shaded Lens**  
Shade 5 IR lens provides infrared light protection for plasma cutting applications  
Order K4969-1



**OMNISHield™ Face Shield**  
Shade 5 IR lens provides infrared light protection for plasma cutting applications  
Order K3754-1

## RECOMMENDED ENGINE DRIVES <sup>(1)</sup>



Ranger® 260 MPX™



Ranger® 330MPX™



Ranger® 330MPX™ EF1



Ranger® AIR 260MPX™



Vantage® 322



Vantage® 549X



Vantage® 566X



Frontier® 400X



Maverick® 325X

<sup>(1)</sup> When run in the high idle mode.

The Tomahawk® 30 Air can be operated on engine driven generators as long as the 230 volt auxiliary meets the following conditions.

- The AC Waveform peak voltage is below 400 volts.
- The AC waveform frequency is between 55 and 65 Hz.
- The RMS voltage of the AC waveform is always greater than 208VAC.

## PRODUCT SPECIFICATIONS

Product Name	Product Number	Input Power	Rated Output Current/Voltage/ Duty Cycle	Input Current @ Rated Output	Output Range	Gas Pressure Required	Gas Flow Rate	Dimensions H x W x D in (mm)	Net Weight lb (kg)
Tomahawk® 30 Air	K5457-1	230/1/60	25A/90V/100% 30A/92V/60%	16A (max)	15-30A	80 to 110 psi (6-75 bar)	70psi @ 125- 200SCFH (5 Bar @ 80 Liters/min)	15.2 (385) 8.5 (215) 18.9 (480)	40 (19)

For best cutting results with Lincoln Electric® equipment, always use Lincoln Electric consumables. Visit [www.lincolnelectric.com](http://www.lincolnelectric.com) for more details.

### CUSTOMER ASSISTANCE POLICY

The business of Lincoln Electric is manufacturing and selling high quality welding equipment, automated welding systems, consumables, and cutting equipment. Our challenge is to meet the needs of our customers, who are experts in their fields, and to exceed their expectations. On occasion, purchasers may ask Lincoln Electric for information or technical information about their use of our products. Our employees respond to inquiries to the best of their ability based on information and specifications provided to them by the customers and the knowledge they may have concerning the application. Our employees, however, are not in a position to verify the information provided or to evaluate the engineering requirements for the particular weldment, or to provide engineering advice in relation to a specific situation. Accordingly, Lincoln Electric does not warrant or guarantee or assume any liability with respect to such information or communications. Moreover, the provision of such information or technical information does not create, expand, or alter any warranty on our products. Any express or implied warranty that might arise from the information or technical information, including any implied warranty of merchantability or any warranty of fitness for any customers' particular purpose or any other equivalent or similar warranty is specifically disclaimed. Lincoln Electric is a responsive manufacturer, but the definition of specifications, and the selection and use of specific products sold by Lincoln Electric is solely within the control of, and remains the sole responsibility of the customer. Many variables beyond the control of Lincoln Electric affect the results obtained in applying these types of fabrication methods and service requirements.

**The Lincoln Electric Company**  
 22801 St. Clair Avenue · Cleveland, OH · 44117 · U.S.A.  
[www.lincolnelectric.com](http://www.lincolnelectric.com)