

POWER WAVE S500 WIRING DIAGRAM G7188 REV: F

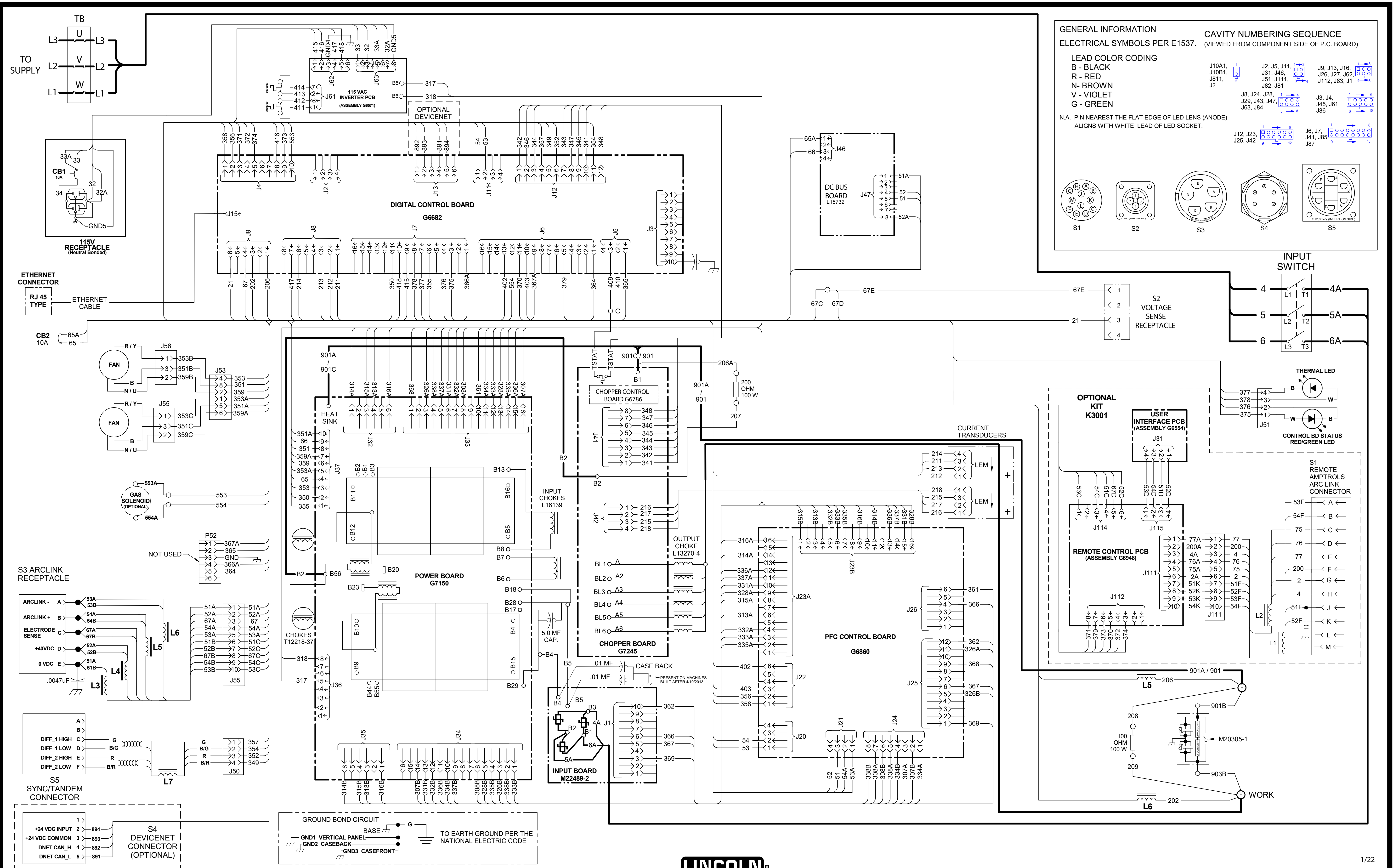

GENERAL INFORMATION

ELECTRICAL SYMBOLS PER E1537.

LEAD COLOR CODING

- B - BLACK
- R - RED
- N - BROWN
- V - VIOLET
- G - GREEN

CAVITY NUMBERING SEQUENCE (VIEWED FROM COMPONENT SIDE OF P.C. BOARD)

J10A1, J10B1, J811, J2
 J2, J5, J11, J31, J46, J51, J111, J82, J81
 J8, J24, J28, J29, J43, J47, J63, J84
 J9, J13, J16, J26, J27, J62, J112, J83, J1
 J3, J4, J45, J61, J86
 J12, J23, J25, J42
 J6, J7, J41, J85, J87

N.A. PIN NEAREST THE FLAT EDGE OF LED LENS (ANODE) ALIGNS WITH WHITE LEAD OF LED SOCKET.

INPUT SWITCH

4 L1 T1 4A
 5 L2 T2 5A
 6 L3 T3 6A

OPTIONAL KIT K3001

USER INTERFACE PCB (ASSEMBLY G6554)

REMOTE CONTROL PCB (ASSEMBLY G6948)

S1 REMOTE AMP/TROLS ARC LINK CONNECTOR

53F A
 54F B
 75 C
 76 D
 77 E
 200 F
 2 G
 4 H
 51F J
 52F K
 L
 M

377
 378
 376
 375

CONTROL BD STATUS RED/GREEN LED

901A / 901

901B

M20305-1

903B

WORK

208
 100 OHM
 100 W
 209

L5

L6

