

REPLACEMENT PARTS LIST  
 SNAP-ON 160 AMP MIG WELDER  
 MODEL **117-056, YA205B**

SERVICING SHOULD BE PERFORMED BY QUALIFIED SERVICE PERSONNEL.

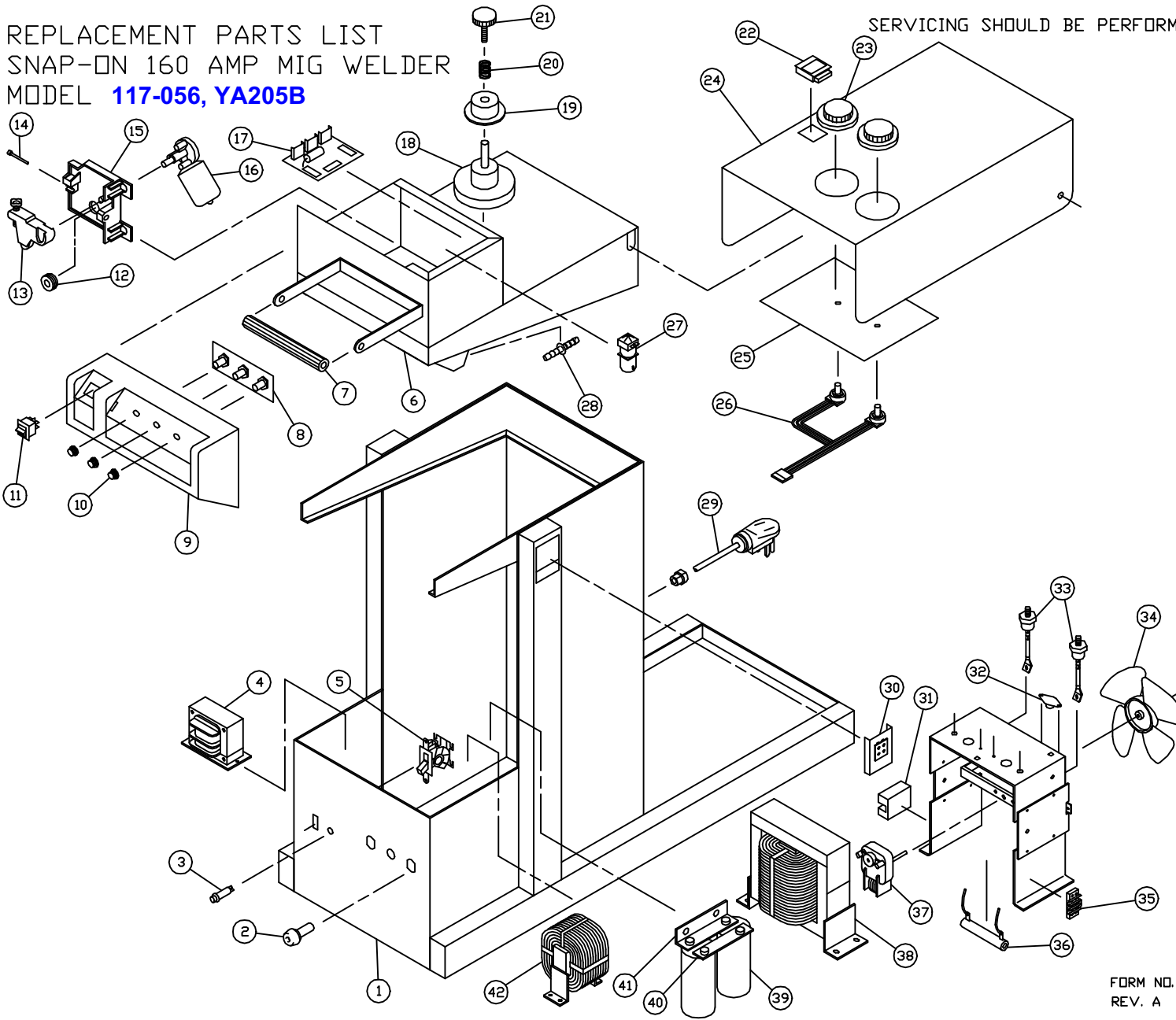

ITEM	DESCRIPTION	NUMBER
1	FRONT PANEL	410-655-026
2	RECEPTACLE ASSEMBLY	312-046-666
3	POWER LIGHT	245-078-666
4	DRIVE TRANSFORMER	880-233-888
5	POWER SWITCH	216-042-666
6	UNDER CARRIAGE ASSEMBLY	880-045-666
7	HANDLE	246-161-666
8	SPOT/SWITCH PCB	880-114-666
9	PLASTIC NOSE W/LABELS	880-081-666
10	KNOB 1" DIA	246-127-666
11	PADDLE SWITCH	216-077-666
12	DRIVE ROLLER (.024/.030/.035)	4323
	.045 SERRATED	310-154-666
	URETHANE ROLLER	4324
13	DRIVE TENSIONER ASSEMBLY	880-111-666
14	INLET GUIDE TUBE	239-123-666
15	DRIVE BASE ASSEMBLY	880-130-666
16	DRIVE MOTOR	216-079-666
17	MAIN PCB	880-113-666
18	SPINDLE	312-066-666
19	SPDDL ADAPTOR	312-110-666
20	SPDDL TENSIONER SPRING	312-029-666
21	SPDDL TENSIONER KNOB	246-215-666
22	SLIDE LATCH	312-042-666
23	KNOB 2.75 DIA	246-158-666
24	HOOD W/LATCH & LABELS	880-240-666
25	DRIVE BOX COVER	410-516-026
26	HEAT/WIRE SPEED HARNESS	
	W/POTENTIOMETER	860-936-666
	POTENTIOMETER ONLY	246-120-666
27	SOLENOID	246-212-666
28	HOSE BARB FITTING	253-047-666
29	POWER CORD W/STRAIN RELIEF	248-254-666
30	DRIVE HEAD LOCK ASSEMBLY	860-627-666
31	TRIAC RELAY	216-062-666
32	THERMOSTAT	216-073-666
33	DIODE	214-004-666
34	FAN BLADE	316-010-666
35	TERMINAL BLOCK	239-164-666
36	RESISTOR ASSEMBLY	880-237-666
37	FAN MOTOR	216-085-666
38	TRANSFORMER	880-232-888
39	CAPACITOR	213-018-666
40	BUSS BAR: FLAT	410-190-666
41	BUSS BAR: L-SHAPED	412-405-666
42	REACTOR	880-236-888
43	RUBBER MAT (NOT SHOWN)	512-046-666
44	COPPER JUMPER BAR	
	(NOT SHOWN)	412-304-666
45	COPPER RING (NOT SHOWN)	412-280-666
46	GUN ASSEMBLY (SEE MANUAL FOR	
	INDIVIDUAL TORCH PARTS)	
	(NOT SHOWN)	238-191-100
47	AXLE W/HUBS AND PINS	
	(NOT SHOWN)	413-035-666
48	WHEEL W/HUB (NOT SHOWN)	413-047-666
49	CASTOR W/HARDWARE	
	(NOT SHOWN)	413-041-666
50	TANK CHAIN (NOT SHOWN)	410-260-666
51	GROUND CABLE & CLAMP	
	(NOT SHOWN)	4007
52	REGULATOR (NOT SHOWN)	334-286-666
	(NOT SHOWN)	
OPTIONS:	UMBILICAL CORD 20 FT Y240-1810-860-100	
	DUST COVERS: SNAP-ON	334-310-100
	CLEAR	334-332-100

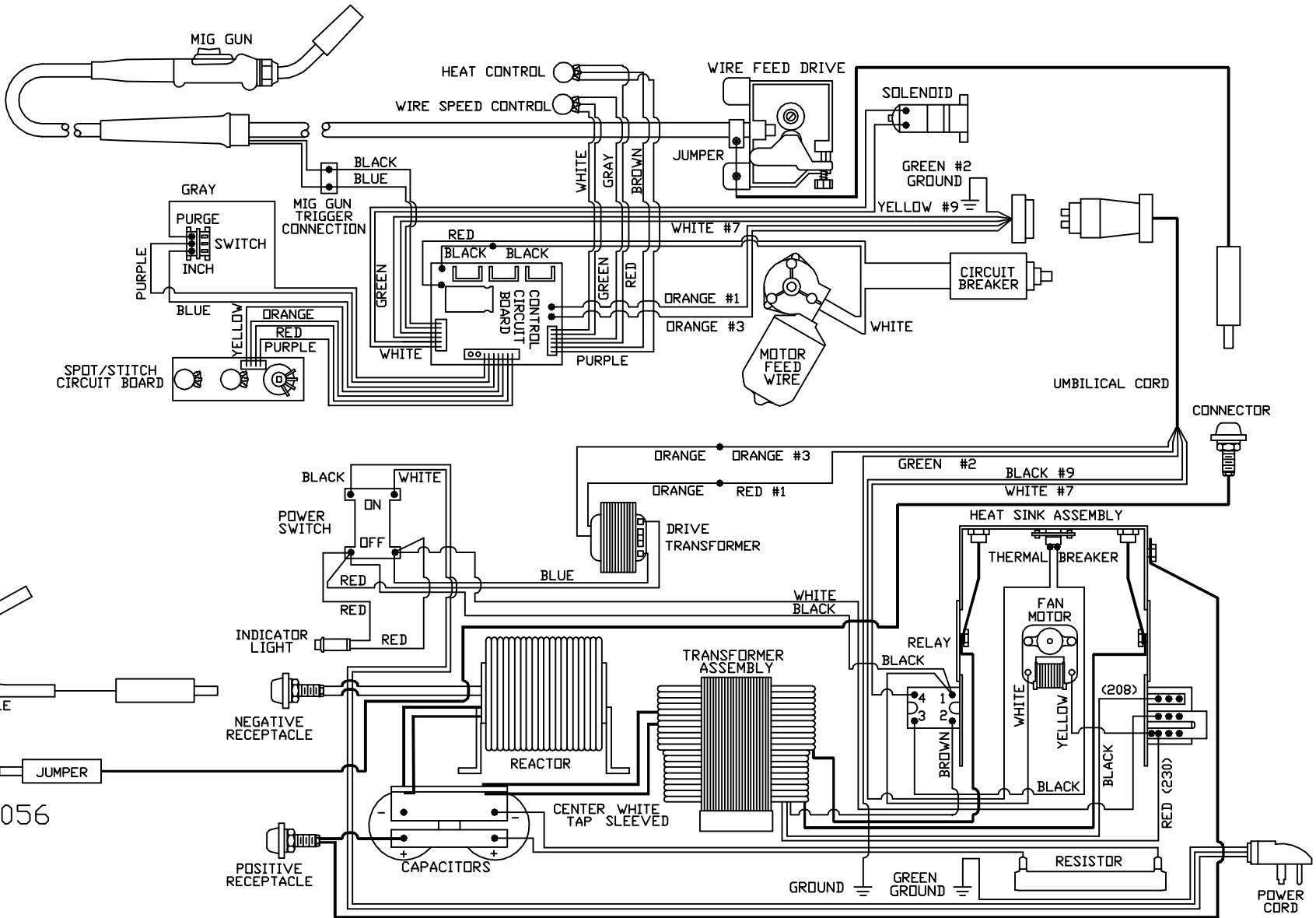

Model 117-056

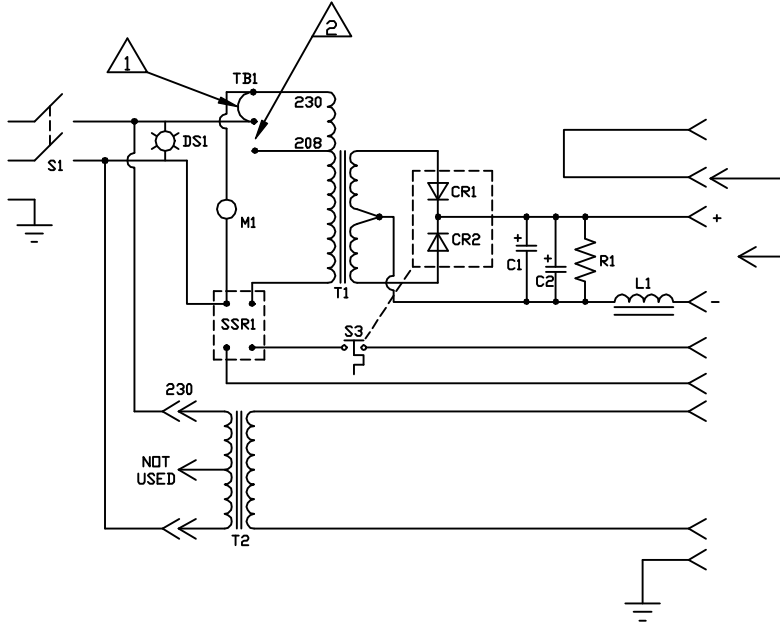

POWER PACK

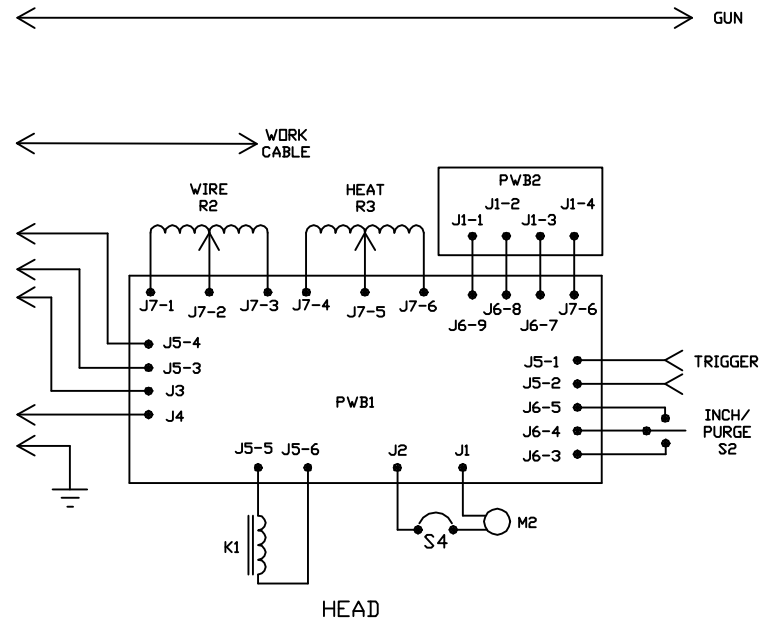

HEAD

# MODELS 117-036, 117-056

NOTES:

- 1 SHOWN WIRED FOR 230 VOLT OPERATION.
- 2 FOR 208 VOLT OPERATION, MOVE JUMPER TO THIS POSITION.

SYM	DESCRIPTION
T1	MAIN TRANSFORMER
T2	CONTROL TRANSFORMER
S1	POWER SWITCH
S2	INCH/PURGE
S3	THERMAL BREAKER
S4	CIRCUIT BREAKER
DS1	INDICATOR LIGHT
SSR1	SOLID STATE RELAY 70A
TB1	TERMINAL BLOCK 208/230V
M1	FAN MOTOR 240V
CR1,CR2	DIODE 150 AMP 300V
C1,C2	CAPACITOR 45,000 MFD 45V
R1	RESISTOR 12.5 OHM 100W
L1	REACTOR 160 AMP
PWB1	CONTROL CIRCUIT BOARD
PWB2	SPOT/STITCH BOARD
K1	GAS SOLENOID N.C.
M2	WIRE FEED DRIVE MOTOR
R2	POTENTIOMETER WIRE SPEED
R3	POTENTIOMETER HEAT CONTROL